

PHOENIX DOWNTOWN CIVIC SPACE SCULPTURE

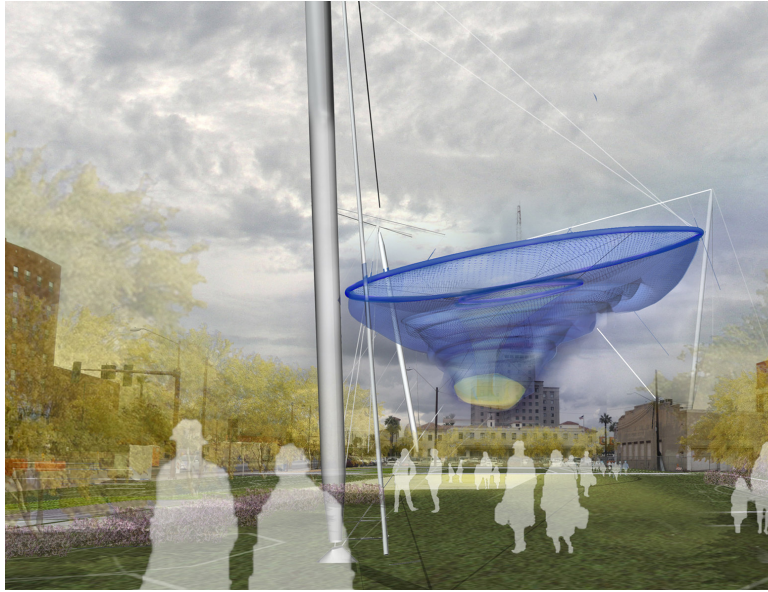

Quick Facts

Location	Downtown Civic Space - Central Avenue and Taylor Street
Monday March 9	Crews will begin installing the sculptural net. The work is expected to take at least three days.
Economic Impact	This \$2.5 million project supported about 150 jobs, 110 of them for Arizona workers. They ranged from engineers, surveyors, architects, cement workers, landscape architects and truckers to electricians, steelworkers, caisson drillers, welders, painters, crane operators and many other trades.
Lighting	Special lighting will give the sculpture a landmark presence at night. The lighting will be completed in March 2009.
Dedication	To be announced.
Engineer's Forum	A forum highlighting the award-winning engineering behind the sculpture's design will be held in April. The date to be announced.
More information	Edward Lebow, Phoenix Office of Arts and Culture 602 495-0197

Title:	<i>Her Secret Is Patience</i>	
Artist:	Janet Echelman (Boston)	
Design and Engineering	CAID Industries (Tucson), Speranza Architecture (Barcelona), M3 Engineers (Tucson), Buro Happold Consulting Engineers, P.C. (NY), Peter Heppel Associates (Paris), EDAW, landscape architects (Phoenix), Paul Deeb, lighting design (Baltimore)	
Fabrication and Installation	CAID Industries, Foresite Design and Construction(Tempe), Nexus Steel, structural steel installation/erection (Tempe), Diamond Nets (WA), Net Services (WA)	
Artist Selection	The city selected Janet Echelman to create a landmark sculpture for the new Downtown Civic Space in early 2007 through an international competition that drew 178 submittals. As with all other city public art projects, a diverse selection panel of community members, artists, public art specialists, stakeholders and city staff recommended the artist. In December 2007, City Council approved the use of percent-for-art funds for CAID Industries to fabricate and install the sculpture.	
Dimensions and Materials	3 Poles	105 feet, 125 feet and 145 feet tall
	2 Rings	Outer: 100 feet wide, Inner: 30 feet wide
	Support Cables	1 ¾ -inch and 1-inch diameter
	Net Width	Top - 100 feet wide; Bottom - 15 feet wide
	Net Height	38 feet above the ground; 98 feet to the top.
	Net Material	Integral color polyester fiber twine and rope
Project Budget	The \$2.5 million project was developed with percent for art funds from the City of Phoenix capital improvement budget. Capital funds must be spent on brick and mortar projects, such as the Civic Space. General purpose funding was not used for this project.	
Awards	2008 Award for Excellence in Structural Engineering from the Arizona Structural Engineers Association (ASEA).	

