



PHOENIX OFFICE OF ARTS AND CULTURE Public Art Program



Photo: Bill Timmerman

Journey Through Nature, 2012
Daniel Martin Diaz
PHX SkyTrain

2013-18 Public Art Project Plan

2013-18 Public Art Project Plan

Table of Contents

	Page
INTRODUCTION AND BACKGROUND	5
PROJECTS (Projects in <i>italics</i> are new projects)	
PUBLIC ART HIGHLIGHTS 2012/13	7
Project Title 7th Avenue at Melrose Curve	12
Project Title 16th Street/Bethany Home Road Streetscape	12
Project Title 24th Street and Baseline Road Park and Ride	13
Project Title <i>North 32nd Street Improvement</i>	13
Project Title 32nd Street Retrofit and Grand Canal	13
Project Title 56th Street Reservoir Streetscape	14
Project Title 67th Avenue Bus Shelters and Streetscape	14
Project Title <i>107th Avenue Streetscape</i>	14
Project Title Arizona Falls	15
Project Title Arterial Canal Crossings	15
Project Title Artists' Initiative V Temporary Projects 2013/2014	16
Project Title Avenida Rio Salado/Broadway Road Streetscape	16
Project Title Aviation Portable Works Collection	16
Project Title Bola Tie Installation on Washington Street	17
Project Title Buckeye Road Streetscape	17
Project Title Connected Oasis	17
Project Title Cultural Voices – Arizona Artists	18
Project Title Deer Valley WTP Wall and Streetscape	18
Project Title <i>Desert Sky Transit Center</i>	19
Project Title Downtown Civic Space	19

2013-18 Public Art Project Plan

Page 3

Project Title	Fire Station # 55	19
Project Title	Fire Station # 74	20
Project Title	Gimme Shelter Urban Shade	20
Project Title	Grand Canal at Central Avenue	20
Project Title	Harmon Branch Library	21
Project Title	Hatcher Road Streetscape	21
Project Title	Highline Canal at Circle K Park – Phase II	21
Project Title	Historic Phoenix Landmarks II	22
Project Title	Isaac Streetscape Phase II	22
Project Title	Kuban Park II	22
Project Title	La Pradera Park	23
Project Title	Lift Station Projects	23
Project Title	Light Rail Corridor	23
Project Title	Matthew A. Henson/HOPE VI Housing Project	24
Project Title	North Transfer Station Recycling Phase III	24
Project Title	Park at 32nd Avenue and McDowell Road (formerly Isaac Park)	24
Project Title	Phoenix Biomedical Campus	25
Project Title	Pinnacle Peak Water Reservoir	25
Project Title	Pioneer Living Heritage Village	25
Project Title	Police Precinct Station # 700	26
Project Title	Police Precinct Station on Greenway Road	26
Project Title	PSHIA PHX Sky Train	26
Project Title	PSHIA PHX Sky Train 44th Street Station Interior	27
Project Title	PSHIA PHX Sky Train Terminal 3 Station	27
Project Title	PSHIA Public Art Master Plan	27
Project Title	PSHIA Terminal Redevelopments	28
Project Title	Public Works - 27th Avenue Solid Waste Management Facility	28

2013-18 Public Art Project Plan

Page 4

Project Title	Pueblo Grande Entrance and Streetscape	28
Project Title	Rio Salado Enhancements	29
Project Title	Roosevelt Street Improvements	29
Project Title	Skunk Creek Recreational Area	29
Project Title	Sonoran Blvd	30
Project Title	South Mountain Library/Western Canal	30
Project Title	Southwest Family Service Center	30
Project Title	SR51 Artwork Refurbishment	31
Project Title	Street Views	31
Project Title	Thomas Road Overpass Artwork Refurbishment	31
Project Title	Tres Rios Wetlands	32
Project Title	Washington Park Tennis Center	32
Project Title	Water Public Art Plan	32
MAJOR MULTI-YEAR PROJECTS		33
SUBSTANTIALLY COMPLETED PROJECTS		34
2013-18 PUBLIC ART PROJECT PLAN SUMMARY		35
INDEX BY COUNCIL DISTRICT		36
INDEX BY FUNDING PROGRAM		39
2013-2018 PUBLIC ART PLAN BUDGET		44

INTRODUCTION AND BACKGROUND

The Phoenix Office of Arts and Culture Public Art Program was established to help create a more beautiful and vibrant City, and to extend the benefits of art and culture throughout Phoenix. Over the past quarter century, the program has involved artists with architects, engineers, landscape architects and City planners in the design and construction of a wide range of award-winning public facilities and spaces, including neighborhood parks, community centers, bridges, plazas, streets, overpasses, recycling centers and other important civic features.

The Public Art Program was established in 1986 through an ordinance that allocates one percent of the City's Capital Improvement Program to public art. Phoenix manages one of the most active municipal percent-for-art programs in the United States, with more than 170 major projects completed since 1986 and 40 projects now in various stages of implementation. The Public Art Program has garnered numerous awards for design excellence, including two Design for Transportation Awards from the U.S. Department of Transportation and the National Endowment for the Arts, numerous Valley Forward Association Environmental Excellence Awards, including the 2001 President's Award, and other local and national recognition. The Public Art Program has brought positive national and international media attention to the City of Phoenix through articles in *The New York Times*, *Newsweek*, *The Wall Street Journal*, *Art in America*, *The Atlantic Monthly* and *Landscape Architecture*, among others.

Each year, the Phoenix Office of Arts and Culture works with funding City departments and the Mayor and City Council to develop the annual Public Art Project Plan that identifies capital improvement projects in all areas of Phoenix that offer the greatest opportunity for artist involvement and public accessibility. The plan is presented to the Mayor and City Council for review and approval. The total budget for each project includes funds to contract for design, fabrication, installation and project administration. Art projects are funded in part through the sale of City-issued bonds, which are repaid with revenue from the City's secondary property tax and enterprise funds. The projects are scheduled to be in step with the City's CIP bond program prioritizations.

For each new project, artists are recommended by a panel that includes artists, arts professionals, staff from the funding City department and representatives of the community where the project is located. The panel reviews applications submitted in response to a Call to Artists. Project architects and City staff may serve as non-voting advisors to the panel. During meetings that are open to the public, the panel reviews each artist for quality of past work, suitability, and evidence of the ability to work well with the community and other design professionals. The panel's recommendation must be reviewed by the Phoenix Arts and Culture Commission, a volunteer citizen advisory board, and approved by the Mayor and City Council before the artist can begin work.

For more information regarding the Phoenix Office of Arts and Culture, please visit phoenix.gov/arts or call (602) 262-4637.

The Phoenix Office of Arts and Culture has developed the FY 2013-18 Public Art Project Plan with input and assistance from the Mayor and City Council, City residents, artists, funding City departments, and the Phoenix Arts and Culture Commission's Public Art Committee.

The FY 2013-18 Public Art Project Plan includes the following types of public art projects:

1. Design Team Projects

Placing artists on design teams to collaborate with architects, landscape architects, engineers, and community members to plan major capital construction projects such as recycling facilities, freeway bridges, streetscape improvements and community centers. Design team projects may result in art elements that are constructed as an integral part of new infrastructure, stand-alone elements built and installed by the artist, or a combination of both.

2. Site Specific Commissions

Artists design and fabricate artwork or artistic enhancements designed for specific locations that reflect the history, use or sense of community for the project site. Site specific commissions may be incorporated into new construction or existing public facilities.

3. Purchase of Existing Artwork

The City maintains an extensive portable works collection that includes approximately 1,000 works of art that are displayed in public buildings.

4. Temporary Commissions

Temporary commissions include a range of short-term projects that provide professional development for artists and that respond to selected locations or opportunities. Temporary projects may include media commissions, temporary sculpture, changing displays, banners, or other displays for a limited time.

5. On-Going Integrated Projects

The City has commissioned a number of artist-designed amenities that may be integrated with new construction or renovation. On-going projects include opportunities such as display banners that are periodically changed to provide new content.

6. Artwork Refurbishment

The City must periodically refurbish public artwork that is part of the City's collection. Sometimes it is necessary to modify existing artworks to adjust to changing site conditions or to renew the appearance of existing artworks that have been exposed to the elements. These modifications go beyond routine artwork maintenance activities.

7. Master Planning

The City periodically develops public art master plans to determine the best opportunities for incorporating art into public projects. Such master plans often recommend specific projects or series of project, and where they should be sited to achieve the greatest public benefit.

PUBLIC ART HIGHLIGHTS 2012/13

Project Title **7th Avenue at Melrose Curve**
Location **7th Ave. and West Glenrosa Street**

Description:

Arizona poets Allyson Boggess; David Chorlton; Joshua Rathkamp; and Rebecca Seiferle's poems about recycling and environmental awareness were combined with photographs by Christopher Colville and Paho Mann in the outdoor gallery for new art at 7th Ave and West Glenrosa Street, in the Melrose Curve.



Project Title **Lift Station #53 at Las Palmaritas**
Location **7th Street and Las Palmaritas**

Description:

CoLab Studio developed the idea for this project because of a community request to improve the appearance of the lift station as part of planned security and equipment upgrades at the site. To improve the look and security of the square building, the artists created a curving decorative steel cornice that runs the 50-foot length of each wall. The daily path of sunlight animates the walls with a slowly moving play of light and shadow. At night, LED backlighting mimics the sun for people walking along the nearby canal and driving along 7th Street. The artists based the cut-out patterns on the flowing shapes of desert and marine flora.



Project Title
Location

PHX SkyTrain - Terminal 4 Connector Bridges – *Trace Elements*
Phoenix Sky Harbor International Airport

Description:

Daniel Mayer, a book artist and master printer, was inspired by the intricate beauty of Arizona leaves for the design of his two large-scale glass murals. Integrated into the design and construction of the pedestrian bridges, each mural is 115 feet long and 9 feet high, consisting of 28 individual laminated glass panels. Mayer designed the mural in a rhythmic book-page sequence. To create the design, he pressed leaves into aluminum foil with an etching press; then he inked the image to bring out the embossed lines and details. He used a digital program to enlarge the “leaf prints” to the size of the murals. The digital images were screen-printed and hand-painted on glass panels with permanent ceramic glazes, then kiln-fired.

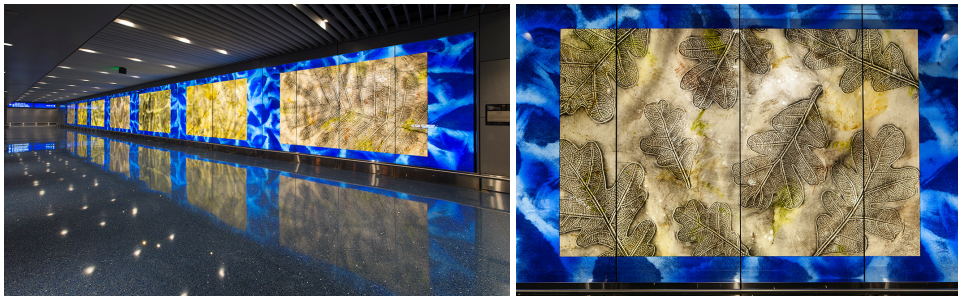

Project Title
Location

PHX SkyTrain - 44th Street Station Ground Floor Atrium
Phoenix Sky Harbor International Airport

Description:

The international team of Mario Madayag (WA), Michael Parekowhai (NZ), and Paul Deeb (AZ) created a work inspired by the vivid blue of the Arizona sky and the ancient history and role of water in shaping the desert. The name *Blue Stratus* refers to a low altitude cloud that forms a continuous horizontal layer. The ceiling was made with 6,610 uniquely shaped aluminum reflector panels. To heighten their atmospheric effects, they were painted six shades of blue and designed to move in the breeze. The team programmed the lights above the ceiling to create a slowly changing tableau of rich color.

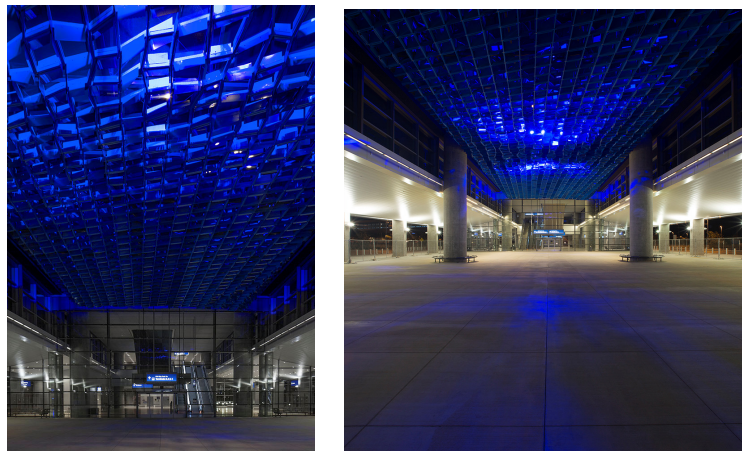

Project Title
Location

PHX SkyTrain - 44th Street Pedestrian Bridge – *Journey Through Nature*
Phoenix Sky Harbor International Airport

Description:

Tucson artist Daniel Martin Diaz combined natural and geometric patterns to create the design for the terrazzo floor of the pedestrian bridge connecting Sky Train to the 44th Street Light Rail station. The patterns shift from richly-colored blossoms and winding ivory vines to crimson diamonds leading to a swirling geometric mandala at mid-bridge. The terrazzo was poured in place between 36,740 linear feet of cut aluminum strips, and includes 34,398 pounds of aggregate comprising a colorful mix of abalone shell, native desert stones and crushed, recycled glass. The aluminum strips are 3/8 of an inch deep.

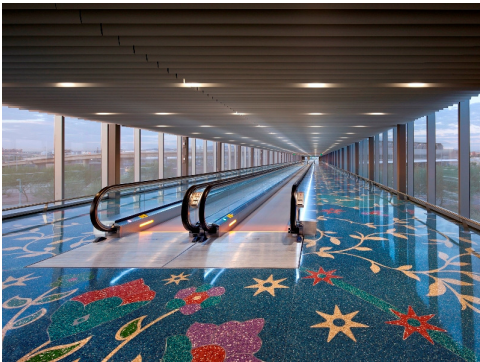

Project Title
Location

PHX SkyTrain - 44th Street Station Platform – *Tail Patterns*
Phoenix Sky Harbor International Airport

Description:

Phoenix artist Fausto Fernandez tapped his love of layered colors and mechanical shapes to design a floor inspired by the outline of an airplane's horizontal stabilizer, known as a tail plane. He used ten colors to create the platform's rhythmic geometric patterns and sweeping bands. He heightened the floor's reflective qualities by adding aggregates of recycled, crushed glass and mirror.



Project Title **PHX SkyTrain - Terminal 4 Station Platform – Variable Order**
Location **Phoenix Sky Harbor International Airport**

Description:

Daniel Mayer, a book and letter press artist who works and teaches at Arizona State University's Herberger Institute of Design and the Arts School of Art, created a terrazzo floor with more than 1,000 embedded aluminum letters. He chose Garamond italic lower-case typeface for the letters because of its calligraphic elegance. Mayer combined the letters with two, large-scale hand-written phrases which say "timeless is the open" and "limitless is the open." He used a terrazzo aggregate of recycled crushed mirror, blue and clear glass, and abalone shell to give the floor's eight colors added vibrancy, depth and detail.



Project Title **PHX SkyTrain - 44th St. East Economy Lot Station Platform – Topo Map**
Location **Phoenix Sky Harbor International Airport**

Description:

Artist Anne Coe is known for her narrative paintings about the connections between the natural and man-made worlds. A fourth generation Arizonan, she drew inspiration for the floor from the colorful topographic maps she uses in hikes through the desert. To create her design, she borrowed the style of "topo" maps, turning the floor into a whimsical landscape of wiggling shapes and lines suggesting such natural features as canyons, rivers and mountains.



Project Title

Reach 11 Sports Complex

Location

Reach 11 – Cave Creek Water Treatment Plant to Tatum

Description:

Description:

Artist Yang Chyi Lee (TX) created shade structures to shelter the athletes of the City of Phoenix's Reach 11 Sports Complex, the largest soccer complex of its kind in Arizona and one of the largest in the western United States. Shade at Reach 11 is perhaps the most necessary landscape feature of the park. With the mercury exceeding 100 degrees for weeks on end from late May through September, there are plenty of reasons to design and invent new forms of shade structures for this site. The 8 shade structures and seating areas provide comfortable gathering places for the players and spectators at two sites near the ball fields. The shade structures vary in height, from 14 feet high to 25 feet wide.



2013-18 PUBLIC ART PROJECT PLAN

(Listed alphabetically – the budget summary in the appendix provides detailed funding information)

Project Title	<u>7th Avenue at Melrose Curve</u>
Project #	AR70100010
Location	7th Avenue and West Glenrosa Street
Type of Project	Temporary Commission
Funding Sources	Public Works Capital Program
13-18 Budget	\$59,160 (non-GO Bonds)
DISTRICT 4	

Description:

This continuing project will feature artwork about recycling, sustainability and the environment by Arizona and national artists produced through a partnership between the Public Works Department and Office of Arts and Culture. The works will broaden City outreach about sustainable resource management practices and be displayed in the three double-sided, back-lighted canopied shelters at 7th Avenue at West Glenrosa Street. The project has featured 34 Arizona artists and 18 poets since it was initiated in FY 2004-05. This project is programmed in FY 2013/14 through FY 2015/16.

Project Title	<u>16th Street/Bethany Home Road Streetscape</u>
Project#	AR63000020
Location	16th Street and Bethany Home Road
Type of Project	Site-Specific Commission
Funding Source	Streets and Neighborhood Services Capital Programs
13-18 Budget	\$36,119 (GO Bonds)
DISTRICT 6	

Description:

The Arizona artist team of Maria Salenger and Jones Studio has been selected to work with the community to design streetscape enhancements that improve pedestrian and transit features as part of Neighborhood Services Department upgrades in the area. The artworks will bolster City and community efforts to enhance economic development at this key intersection. Approximately \$39,941 is expected to be spent or encumbered on this project in FY 2012/13.

Project Title	<u>24th Street and Baseline Road Park and Ride</u>
Project #	AR67000009
Location	24th Street and Baseline Road.
Type of Project	Site-Specific Commission
Funding Source	Public Transit Capital Program
13-18 Budget	\$51,000 (non-GO Bonds)
DISTRICT 8	

Description:

Artist Mary Lucking (AZ) has been commissioned to work with the Public Transit Department and the project design team to design shade structures to improve passenger comfort a new park-and-ride facility at 24h Street and Baseline Road. The enhancements are expected to be built as part of the overall project's construction, in FY 2013/14. Approximately \$8,000 is expected to be spent or encumbered on this project in FY 2012/13.

Project Title	<u>North 32nd Street Improvement</u>
Project #	AR63000030
Location	32nd Street, from Shea Boulevard to Cactus Road
Type of Project	Site-Specific Commission
Funding Source	Streets Capital Program
13-18 Budget	\$158,000 (\$58,000 GO; \$100,000 non-GO)
DISTRICT 3	

Description:

An Arizona artist or artist team will be commissioned to work with City Departments and the community to design integrated artworks as part of the Street Transportation Department's improvement of 32nd Street in the vicinity of Shea Boulevard. The project would improve the pedestrian experience of the street and its surrounding neighborhood and businesses. This project is programmed in FY 2013-14.

Project Title	<u>32nd Street Bridge Retrofit and Grand Canal</u>
Project #	AR84850023
Location	Grand Canal, from 32nd Street to 44th Street
Type of Project	Site-Specific Commission
Funding Source	Streets and Water Capital Programs
13-18 Budget	\$53,115 (\$3,115 non-GO; \$50,000 GO Bonds)
DISTRICT 8	

Description:

An artist or artist team will be commissioned to work with City Departments and the community to design pedestrian enhancements and artworks to mark the Grand Canal crossings and improve linkage to the canal trail, which extends from 32nd Street to 44th Street, adjacent to the Pueblo Grande Museum. The improvements would bring more pedestrian amenities to the street and canal corridor. This project is programmed in FY 2016/17.

Project Title **56th Street Reservoir Streetscape**
Project # **AR84850027**
Location **56th Street and Deer Valley Road**
Type of Project **Design Team**
Funding Source **Water Capital Program**
13-18 Budget **\$100,000 (non-GO Bonds)**
DISTRICT 2

Description:

An artist will be commissioned to work with a design team to enhance the streetscape adjacent to the 56th Street Reservoir Facility when the Deer Valley Road extension occurs. The Deer Valley Road extension is slated to be built by private developers. This project is programmed in FY 2015/16 through FY 2016/17.

Project Title **67th Avenue Bus Shelters and Streetscape**
Project # **AR67000006**
Location **67th Avenue, between McDowell and Camelback Roads**
Type of Project **Site-Specific Commission**
Funding Source **Streets & Economic Development Capital Programs**
13-18 Budget **\$88,000 (GO Bonds)**
DISTRICTS 5 & 7

Description:

Artist Leticia Huerta (TX) was commissioned to develop designs to enhance bus and shade shelters integrated into streetscape improvements along 67th Avenue, from McDowell Road to Camelback Road as part of Westside Revitalization efforts. Approximately \$137,547 is expected to be spent or encumbered on this project in FY 2012/13. This project is programmed in FY 2016/17.

Project Title **107th Avenue Streetscape**
Project # **AR63000031**
Location **107th Avenue between Indian School and Camelback Roads**
Type of Project **Site-Specific Commission**
Funding Source **Streets Capital Program**
13-18 Budget **\$100,000 (non-GO funds)**
DISTRICT 5

Description:

An Arizona artist or artist-led team will be commissioned to work with City Departments and the community to design a streetscape that will enhance 107th Avenue between Indian School and Camelback Roads. The improvements would improve pedestrian amenities in the area. This project is programmed in FY 13/14

Project Title Arizona Falls
Project # AR84850019
Location Arizona Canal at 56th Street
Type of Project Artwork Refurbishment
Funding Source Water Capital Program
13-18 Budget \$35,200 (non-GO Bonds)
DISTRICT 6

Description:

Safety features, such as fencing, will be upgraded as part of site renovations to improve the visitor experience of this award-winning project. The renovations are necessary to enhance the durability and safety of security barriers at the site. This project is programmed in FY 2015/16.

Project Title Arterial Canal Crossings and Trail Connections
Project # AR63000013
Location Various
Type of Project Site-Specific Commission
Funding Source Streets and Water Capital Programs
13-18 Budget \$347,557 (non-GO Bonds)
CITYWIDE

Description:

An artist or artist team will be selected to work with the community, City departments and the Salt River Project to improve the safety and connectivity of major street and trail crossings along the Grand Canal through central Phoenix. The Grand Canal's trail system could provide a bicycle- and walker-friendly transportation corridor linking neighborhoods and amenities in central Phoenix to such landmarks as Pueblo Grande, Phoenix Sky Harbor, and Valley Metro Light Rail. This project will integrate designs into the canal bridges and could include path improvements, lighting, trail markers and shade features. Design and construction of these improvements could qualify for the use of SRP Aesthetics Funds. Approximately \$10,243 is expected to be spent or encumbered on this project in FY 2012/13. This project is programmed in FY 2012/13 through FY 2015/16.

Project Title	<u>Artists' Initiative VI Temporary Projects 2013/2014</u>
Project #	AR74000014
Location	Various Sites
Type of Project	Temporary Commissions
Funding Source	Parks and Wastewater Capital Programs
13-18 Budget	\$54,417 (\$17,307 GO; \$37,110 non-GO Bonds)
DISTRICT 7 & 8	

Description:

This continues a successful effort to provide increased opportunities and professional development for Arizona artists working in a variety of media, including performance and new technologies to project images. The project received a National Endowment for the Arts "Our Town" grant in FY 2012/13, to supplement available city funds to commission Arizona and National artists to create temporary works at key sites with wide public access along the Light Rail corridor, and at selected parks and public spaces. The works will be documented and made available online, presenting Arizona artists to a world-wide audience. This multi-year project was initiated in FY 2003-04. Approximately \$79,435 is expected to be spent or encumbered on this project in FY 2012/13. This project is programmed through FY 2013/14.

Project Title	<u>Avenida Rio Salado/Broadway Road Streetscape</u>
Project #	AR84900008
Location	Broadway Road, 7th Street to 51st Avenue
Type of Project	Design Team Commission
Funding Source	Wastewater & Streets Capital Programs
13-18 Budget	\$751,062 (\$46,000 GO; \$705,062 non-G.O Bonds)
DISTRICT 7 & 8	

Description:

The artist team of Matthew Moore (AZ) and Mark Ryan (AZ) were commissioned to join a design team to work with City Departments and the community to design future streetscape enhancements along a segment of Avenida Rio Salado/Broadway Road from 7th Street to 51st Avenue. The artists are developing ideas that can be integrated into the project's overall landscape design. Approximately \$115,161 is expected to be spent or encumbered on this project in FY 2012/13. This project is programmed in FY 2013/14 through FY 2016/17.

Project Title	Aviation Portable Works Collection
Project #	AR66000021
Location	Phoenix Sky Harbor International Airport
Type of Project	Purchase and Commissioning of Existing Artworks
Funding Source	Aviation Capital Program
13-18 Budget	\$120,000 (non-GO bonds)
DISTRICT 8	

Description:

Artworks will be commissioned and purchased to support and expand the programming of the Phoenix Airport Museum over the next five years. Projects could include 1) purchasing recommended works from temporary museum exhibitions and POAC projects for the museum's permanent collection, and 2) purchasing collections of works by contemporary ceramists and other artists. POAC staff will work closely with the Aviation Department to identify the Portable Works projects. This project is programmed in FY 2013/14 through FY 2016/17.

Project Title	<u>Bola Tie Installation on Washington Street</u>
Project #	AR84900006
Location	Washington, between 2nd and 3rd Streets
Type of Project	Artwork Refurbishment
Funding Source	Wastewater Capital Program
13-18 Budget	\$35,000 (non-GO Bonds)
DISTRICT 8	

Description:

Approximately 60 bronze bola ties designed by the late Arizona artist Michael Maglich have been relocated from their former site at Phoenix Convention Center to a new wall adjacent to the light rail station on Washington Street, just south of Symphony Hall. In addition to the relocation, this project will hire an Arizona graphic designer to produce a tour guide of public art projects downtown for the use of City residents and visitors. This project is programmed in FY 2013/14 and FY 2015/16.

Project Title	<u>Buckeye Road Streetscape</u>
Project #	AR63000023
Location	16th Street to Central Avenue
Type of Project	Site-Specific Commission
Funding Source	Streets Capital Program
13-18 Budget	\$107,000 (\$22,503 GO, \$84,497 non-GO Bonds)
DISTRICT 8	

Description:

An artist will be commissioned to work with the community and City departments to develop streetscape enhancements along Buckeye Road, from Phoenix Sky Harbor International Airport to Central. This project will be coordinated with a streetscape improvement project undertaken by the Street Transportation Department. Due to changes in the Capital Improvement Program, the GO-funded portion of this project is expected to be implemented in FY 2016/17.

Project Title	<u>Connected Oasis</u>
Project #	AR84850012
Location	Downtown Phoenix
Type of Project	Site-Specific Commission
Funding Source	Water Capital Program
13-18 Budget	\$60,000 (non-GO Bonds)
DISTRICTS 7 & 8	

Description:

Artists have been selected to develop public art projects that advance the City's vision of creating a vibrant connected oasis downtown of shaded streetscapes, sidewalks, public spaces, transit connections, artworks and other urban amenities. In its initial phase, this project funded:

- Artist Jack Mackie's (WA) participation on the Phoenix Downtown Urban Form Plan consultant team led by the planning firm of Dyett and Bahtia (CA). The team was hired in FY 2005/06 to develop the City's Downtown Urban Form Plan. Its work is being coordinated by the Phoenix Planning Department;
- Mackie's participation with landscape architect Christy Ten Eyck in the design of enhancements for Taylor Street as part of the new downtown ASU campus. That project was coordinated by the Phoenix Street Transportation Department. The first phase of construction was completed early in FY 2008/09;
- Planning and development of the ASU Journalism Building Public Art Project;

2013-18 Public Art Project Plan

Page 18

- Planning and development of the Downtown Civic Space Public Art Project;
- Gimme Shelter Urban Shade Public Art Project; and
- Planning and development of the Phoenix Bio-Medical Campus Public Art Project

This phase of the project will identify public art projects and opportunities in conjunction with the development of future pedestrian and streetscape enhancement projects downtown. This continues a project initiated in FY 2005/06. Approximately \$3,865 is expected to be spent or encumbered in FY 2012/13. This project is programmed in FY 2013/14.

Project Title	<u>Cultural Voices – Arizona Artists</u>
Project #	AR75000006
Location	Various
Type of Project	Site-Specific Commission
Funding Sources	Library Capital Program
13-18 Budget	\$40,000 (GO Bonds)
CITYWIDE	

Description:

Leading Arizona artists and cultural figures will be interviewed as part of the Centennial's effort to document and present important aspects of Arizona's evolution in the past 100 years. The interviews will be recorded, made available through the web, and coordinated with the Phoenix Library Department's oral history project. Due to changes in the Capital Improvement Program, this project is expected to be implemented in FY 2016/17.

Project Title	<u>Deer Valley WTP Wall and Streetscape</u>
Project #	AR84850018
Location	Dunlap Avenue, between 29th and 34th Avenues
Type of Project	Site-Specific Commission
Funding Source	Water Capital Program
13-18 Budget	\$233,000 (non-GO Bonds)
DISTRICT 1	

Description:

Artist John Runnels (TX) has been commissioned to design enhancements for the security wall along the Dunlap Avenue side of the Deer Valley Water Treatment Plant. The artist has worked with students at Cortez High School, community residents and City staff to develop the project, which will include specialized wall treatments, enhanced landscaping and new transit shelters at existing bus stops in front of the wall along the Dunlap Avenue sidewalk. These are expected to be installed in FY 2013-14. Approximately \$7,655 is expected to be spent or encumbered on this project in FY 2012/13. This project is programmed in FY 2013/14.

Project Title *Desert Sky Transit Center*
Project # AR67000010
Location 79th Avenue and Thomas Road
Type of Project Design Team Commission
Funding Source Public Transit Capital Program
13-18 Budget \$20,000 (non-GO Bonds)
DISTRICTS 5 & 7

Description:

An artist will be commissioned to work with the Public Transit Department and the project design team to design shade structures and related necessities to improve passenger comfort at the Desert Sky Transit Center. The enhancements would be built as part of the project's overall construction. This project is programmed in FY 2013-14.

Project Title **Downtown Civic Space**
Project# AR67000003
Location New Downtown Civic Space, Central Avenue/Taylor Street
Type of Project Site-Specific Commission
Funding Source Wastewater Capital Program
13-18 Budgets \$13,791 (non-GO Bonds)
DISTRICT 7

Description:

Artist Janet Echelman (MA) created a major work of outdoor sculpture as part of the new 2.7-acre Downtown Civic Space. The work, for which planning began in FY 2006-07, was fabricated and installed in conjunction with construction of the Civic Space in FY 2008-09 by Caid Industries in Tucson. This phase of the award-winning project would enable final project closeout. Approximately \$639 is expected to be spent or encumbered on this project in FY 2012/13.

Project Title **Fire Station # 55**
Project# AR57000007
Location Deer Valley Road and North Gateway
Type of Project Site-Specific Commission
Funding Source Fire Capital Program
13-18 Budget \$107,000 (GO Bonds)
DISTRICT 1 & 2

Description:

Arizona artist Carrie Seid has been selected to design enhancements for the public areas of Fire Station #55. The designs will be incorporated into the built station. The project schedule depends upon modifications to the City's Capital Improvement Program. This continues a project begun in FY 2007-08. Due to changes in the Capital Improvement Program, this project is expected to be implemented in FY 2016/17.

Project Title **Fire Station # 74**
Project # **AR57000009**
Location **19th Avenue and Chandler Boulevard**
Type of Project **Site-Specific Commission**
Funding Source **Fire Capital Program**
13-18 Budget **\$120,000 (GO Bonds)**
DISTRICT 6

Description:

An Arizona artist will be selected to design enhancements for the public areas of Fire Station #74. The designs will be incorporated into the built station. Due to changes in the Capital Improvement Program, this project is expected to be implemented in FY 2016/17.

Project Title **Gimme Shelter Urban Shade**
Project # **AR84850025**
Location **Pierce Street, between Central Avenue and 1st Street**
Type of Project **Site-Specific Commission**
Funding Source **Water, Streets and Economic Development Capital Programs**
13-18 Budget **\$515,368 (\$6,400 GO; \$508,968 non-GO Bonds)**
DISTRICTS 7 & 8

Description:

The design team of Gavan & Barker, Inc. (AZ) and MATTER Architectural Practice (NY) has been commissioned to design shade and landscape enhancements for Pierce Street, from Central Avenue to 1st Street in front of the new Downtown Phoenix Public Market. The project will bolster Phoenix's efforts to revitalize its urban core as a connected oasis by integrating shade structures into streetscape and other essential roadside improvements along Pierce Street downtown. This project received a National Endowment for the Arts Mayor's Institute of Design 25th Anniversary grant to assist with design. Approximately \$12,675 is expected to be spent or encumbered on this project in FY 2012/13. This project is programmed in FY 2013/14.

Project Title **Grand Canal at Central Avenue**
Project# **AR84850010**
Location **Grand Canal between 7th Avenue and Central Avenue**
Type of Project **Design Team Commission**
Funding Source **Water Capital Program**
13-18 Budget **\$105,000 (non-GO Bonds)**
DISTRICT 4

Description:

An artist and Arizona landscape architect will be selected to design trail enhancements at the 7th Avenue crossing of the Grand Canal and the link to light rail station at Central Avenue and Campbell. The upgraded crossing and trail would continue the Public Art Program and City efforts to improve pedestrian and bicycle corridors linking neighborhoods to light rail and other regional alternative transportation systems. This project could qualify for use of S.R.P Aesthetics Funds and other non-City funds. This project is programmed in FY 2014/15 and FY 2015/16.

Project Title **Harmon Branch Library**
Project # **AR75000004**
Location **411 West Yavapai Street**
Type of Project **Site-Specific Commission**
Funding Sources **Library Capital Program**
12-17 Budget **\$35,000 (GO Bonds)**
DISTRICT 8

Description:

Artist Stacey Levy (PA) was commissioned to work with City Departments, the community and the Arizona architecture firm Richard/Bauer to develop an outdoor public art project that enhances the link between Harmon Park and the new Harmon Branch Library. The project was substantially completed in FY 2010/11. This phase of the project will add shade structures for the library's community garden. Approximately \$9,381 is expected to be spent or encumbered on this project in FY 2012/13. Shade structures will be added to the library garden.

Project Title **Hatcher Road Streetscape**
Project # **AR63000021**
Location **Hatcher Road, Central Avenue to 5th Street**
Type of Project **Site-Specific Commission**
Funding Source **Streets and Neighborhood Services Capital Programs**
13-18 Budget **\$138,634 (GO bonds)**
DISTRICT 3

Description:

Artist Gordon Huether (CA) has been commissioned to work with the community and City departments to design pedestrian amenities to improve the streetscape along Hatcher Road, between Central Avenue and 5th Street, in Sunnyslope. This project will be coordinated with the development of the Street Transportation Department's streetscape improvements along Hatcher. Approximately \$39,000 is expected to be spent or encumbered on this project in FY 2012/13. This project is programmed in FY 2013/14.

Project Title **Highline Canal at Circle K Park – Phase II**
Project # **AR63000024**
Location **Highline Canal at Circle K Park**
Type of Project **Site-Specific Commission**
Funding Source **Storm Sewers Capital Program**
13-18 Budget **\$10,000 (GO Bonds)**
DISTRICT 8

Description:

The Arizona engineering firm of Gavan & Barker was hired to work with City Departments and the artist/landscape architect team of Mags Harries (MA), Lajos Heder (MA) and Christy Ten Eyck (AZ) to design flood remediation at Circle K Park, and, if SRP Aesthetics Funds are available, extend the Highline trail improvements to Central Avenue. Phase II has received a grant from the Flood Control District of Maricopa County. Approximately \$805,204 is expected to be spent or encumbered on this project in FY 2012/13. This project is programmed in FY 2013/14.

Project Title	<u>Historic Phoenix Landmarks II</u>
Project #	AR46000003
Location	Various
Type of Project	Publication
Funding Sources	Historic Preservation and Neighborhood Services Capital Programs
13-18 Budget	\$11,114 (GO Bonds)
CITYWIDE	

Description:

Arizona artist Patrick Madigan was commissioned in 2009 to create a portfolio of photographs depicting 25 historic Phoenix landmarks and buildings to commemorate the 25th year of Historic Preservation in the City. The second phase of this project combined these images with information about these sites in the form of a postcard book, and will be displayed as part of the year-long Centennial celebration, in the fall of 2012. Approximately \$6,000 is expected to be spent or encumbered on this project in FY 2012/13. This project is programmed in FY 2013/14.

Project Title	<u>Isaac Streetscape Phase II</u>
Project #	AR84900012
Location	35th Avenue and McDowell Road
Type of Project	Design Team Commission
Funding Sources	Wastewater Capital Program
13-18 Budget	\$65,000 (non-GO Bonds)
DISTRICT 4	

Description:

Through this West Phoenix Revitalization public art project, artist Rosemary Lonewolf (NM) was contracted in FY 2006-07 to join the engineering team designing a new pedestrian bridge at 34th Avenue and McDowell Rd and artist Leticia Huerta (TX) was contracted to design a streetscape and new bus shelters to improve pedestrian connections and transit facilities on McDowell Rd and 35th Avenue in the Isaac neighborhood. The bridge Phase I and streetscape improvements were completed in 2009/10. As part of the Phase II improvements, additional streetscape enhancements would be extended to and coordinated with the development of the unnamed Park at 32nd Avenue and McDowell Rd. The project schedule depends upon modifications to the City's Capital Improvement Program. This project is programmed in FY 2014/15.

Project Title	<u>Kuban Park Phase II</u>
Project #	AR74000011
Location	32nd Avenue and West Buckeye Road
Type of Project	Site-Specific Commission
Funding Sources	Wastewater Capital Program
13-18 Budget	\$29,000 (non-GO Bonds)
DISTRICT 7	

Description:

Arizona Artist Barbara Grygutis was commissioned to work with City Departments, the community and Kuban School to design improvements, such as fences, pathways and sustainable landscaping, for this new City park. Construction is expected to be completed in FY 2010-11. Phase II of this project would commission an artist to work with the community to develop an artwork for the restroom building at the older portion of the park. Approximately \$3,666 is expected to be spent or encumbered on this project in FY 2012/13. This project is programmed in FY 2013/14.

Project Title **La Pradera Park**
Project # **AR74000012**
Location **39th Avenue and Glendale Avenue**
Type of Project **Design Team Commission**
Funding Sources **Wastewater Capital Program**
13-18 Budget **\$257,880 (non-GO Bonds)**
DISTRICT 5

An artist will be selected to design artworks for a proposed community center at La Pradera Park. This continues a project begun in FY 2007/08. The project schedule will depend upon modifications to the City's Capital Improvement Program. This project is programmed in FY 2014/15 and FY 2015/16.

Project Title **Lift Station Projects**
Project # **AR84900011**
Location **Citywide**
Type of Project **Site-Specific Commission**
Funding Sources **Wastewater Capital Program**
13-18 Budget **\$122,908 (non-GO Bonds)**
CITYWIDE

Description:

Artists will be selected to enhance the design of new or upgraded City lift stations. In addition to wall enhancements, the projects could include enhanced landscaping and fencing. This project is programmed in FY 2015/16.

Project Title **Light Rail Corridor**
Project # **AR63000014**
Location **19th Avenue, from Bethany Home Road to Dunlap Avenue**
Type of Project **Site-Specific Commission**
Funding Sources **Wastewater Capital Program**
13-18 Budget **\$250,000 (non-GO Bonds)**
DISTRICT 5

Description:

The artist team coLab (AZ) has been commissioned to work with City Departments, Valley Metro and community representatives to design walls and landscaping as part of the streetscape enhancements along 19th Avenue in conjunction with the future development of the Light Rail corridor. The first phase of improvements, including landscaping and artist-designed gabion – rather than standard masonry block – walls, was completed late in FY 2010/11. The second phase of this project would involve the artist team with the community, City Departments and consultants to develop artworks along the street in conjunction with future light rail construction. Approximately \$34,000 is expected to be spent or encumbered on this project in FY 2012/13. The enhancements will be phased to accompany streetscape improvements associated with light rail development. This project is programmed in FY 2013/14 and FY 2014/15.

Project Title	<u>Matthew A. Henson/HOPE VI Housing Project</u>
Project #	AR88000005
Location	7th Avenue and Grant Street
Type of Project	Site-Specific Commission
Funding Sources	Water Capital Program
13-18 Budget	\$10,000 (GO Bonds)
DISTRICT 8	

Description:

Joe Willie Smith (AZ) and John Randall Nelson (AZ) have been commissioned to work with City Departments including Housing, Parks and Recreation, Historic Preservation and the Matthew A. Henson/HOPE VI Housing Project team to design and fabricate gates and fences for community gardens at the site. To complete the project, the artists will create seating for the gardens. This continues a project begun in FY 2004-05. Approximately \$18,744 is expected to be spent or encumbered on this project in FY 2012/13. This project is scheduled to be completed in FY 2013/14.

Project Title	<u>North Transfer Station Recycling Phase III</u>
Project #	AR70000003
Location	30101 North Black Canyon Highway
Type of Project	Site-Specific Commission
Funding Sources	Solid Waste Capital Program
13-18 Budget	\$85,000 (non-GO Bonds)
DISTRICT 2	

Description:

This phase of the North Transfer Station Recycling project will build upon the success of the artist-designed recycling education programming developed in previous phases. Phase I included the creation of an exhibition gallery of artists' photographs about recycling for the 10,000 school children who visit annually. Phase II produced an interactive digital kiosk and web site about recycling for on-site and online visitors. Phase III will produce additional recycling-related displays of artworks that bolster the Public Works Department's efforts to create greater awareness about recycling citywide. Approximately \$1,941 is expected to be spent or encumbered on this project in FY 2012/13. This project is programmed in FY 2013/14 and FY 2015/16.

Project Title	<u>Park at 32nd Avenue and McDowell Road (formerly Isaac Park)</u>
Project #	AR74000010
Location	32nd Avenue and McDowell Road
Type of Project	Design Team Commission
Funding Source	Wastewater Capital Program
13-18 Budget	\$204,234 (non-GO Bonds)
DISTRICT 4	

Description:

An artist will be selected to serve as a member of a design team to develop designs for the new Isaac Park. The public art enhancements at the park will complete the package of public art projects planned for the Isaac neighborhood. They include new bus shelters and an enhanced streetscape designed by artist Leticia Huerta (TX) in the vicinity of 35th Avenue and McDowell Road, and a new pedestrian bridge, designed through a collaboration between artist Rosemary Lonewolf (NM) and Jacobs Engineering. This continues a project begun in FY 2007-08. The design work would be scheduled to coincide with the development of the park. The project schedule depends upon modifications to the City's Capital Improvement Program. This project is programmed in FY 2015/16 and FY 2016/17.

Project Title	<u>Phoenix Biomedical Campus</u>
Project #	AR87000007
Location	7th Street and Van Buren Street
Type of Project	Site-Specific Commission
Funding Source	Economic Development; Water; Streets and Parks Capital Programs
13-18 Budget	\$387,449 (\$374,605 GO; \$12,844 non-GO Bonds)
DISTRICT 8	

Artist Meeson Pae Yang (CA) has been commissioned to work with the downtown community and the Biomedical Campus design team to create major outdoor artworks for the new City-owned Phoenix Biomedical Campus (PBC). The urban biomedical campus is a 28-acre urban research park planned for six million sq. ft. of biomedical related research, laboratory, and academic facilities. The PBC project is part of the 2004 "Downtown Phoenix: A Strategic Vision and Blueprint for the Future" which establishes a roadmap for the next 10 years of downtown development. Approximately \$1,156 is expected to be spent or encumbered on this project in FY 2012/13. Due to changes in the Capital Improvement Program, this project is expected to be implemented in FY 2016/17.

Project Title	<u>Pinnacle Peak Water Reservoir</u>
Project #	AR84850024
Location	56th Street and Deer Valley Road
Type of Project	Design Team
Funding Source	Water Capital Program
13-18 Budget	\$116,000 (non-GO Bonds)
DISTRICT 2	

Description:

The Arizona artist team of Nina Solomon and Heidi Dauphin has been commissioned to work with City departments, design consultants and the community to design enhancements for the new 5 million gallon concrete reservoir, to be located at the northeast corner of 56th Street (alignment) and Pinnacle Peak Road. The artwork includes a vehicular gate and relief patterns on the walls surrounding the water reservoir. Construction commenced in FY 2012/13, and is expected to be completed in FY 2014/15. Approximately \$390,243 is expected to be spent or encumbered on this project in FY 2012/13.

Project Title	<u>Pioneer Living Heritage Village</u>
Project #	AR74000015
Location	3901 W. Pioneer Rd
Type of Project	Site-Specific Commission
Funding Source	Parks and Recreation Capital Program
13-18 Budget	\$120,000 (GO Bonds)
DISTRICT 1	

An Arizona artist will be commissioned to work with the community and City Departments to create gates marking the entrance to the Living Heritage Village. Due to changes in the Capital Improvement Program, this project is expected to be implemented in FY 2016/17.

Project Title **Police Precinct Station # 700**
Project # **AR48000007**
Location **24th Street and Lincoln**
Type of Project **Site-Specific Commission**
Funding Source **Police Capital Program**
13-18 Budget **\$230,179 (GO Bonds)**
DISTRICT 6

Description:

An artist will be commissioned to work with the Police Department and the community to create an artwork to enhance the new precinct station at the 24th Street site. Due to changes in the Capital Improvement Program, this project is expected to be implemented in FY 2016/17.

Project Title **Police Precinct Station on Greenway Road**
Project # **AR48000006**
Location **2222 West Greenway Road (Former Game and Fish Building)**
Type of Project **Site-Specific Commission**
Funding Source **Police Capital Program**
13-18 Budget **\$186,780 (GO Bonds)**
DISTRICT 3

Description:

An Arizona artist will be commissioned to work with the Police Department, its consultants and the community to enhance the design of a planned precinct station at the former site of the Arizona State Game and Fish office on Greenway Road. Due to changes in the Capital Improvement Program, this project is expected to be implemented in FY 2016/17.

Project Title **PSHIA PHX Sky Train**
Project # **AR66000022**
Location **Phoenix Sky Harbor International Airport**
Type of Project **Site-Specific Commission**
Funding Source **Aviation Capital Program**
13-18 Budget **\$30,000 (non-GO Bonds)**
DISTRICT 8

Description:

Phoenix Office of Arts and Culture staff will work closely with the Aviation Department to develop public art projects to integrate into future phases of the PHX Sky Train. Approximately \$216 is expected to be spent or encumbered on this project in FY 2012/13. This project is programmed in FY 2013/14 and FY2014/15.

Project Title	<u>PSHIA PHX Sky Train 44th Street Station Interior</u>
Project #	AR66000029
Location	Phoenix Sky Harbor International Airport
Type of Project	Design Team Commission
Funding Source	Aviation Capital Program
12-17 Budget	\$12,765 (non-GO Bonds)
DISTRICT 8	

Description:

Artists Mario Madayag and Michael Parekowhai (NZ), with Paul Deeb were commissioned to work with the Aviation Department, the Office of Arts and Culture and the Automated Train (AT) design team to create an artwork for the ceiling of the PHX SkyTrain station at 44th Street and Washington. The project was substantially completed in FY 2012-13. Approximately \$7,500 is expected to be spent or encumbered on this project in FY 2012/13. This project is expected to close out in FY 2013/14.

Project Title	<u>PSHIA PHX Sky Train Terminal 3 Station</u>
Project #	AR66000025
Location	Phoenix Sky Harbor International Airport
Type of Project	Site-Specific Commission
Funding Source	Aviation Capital Program
13-18 Budget	\$50,185 (non-GO Bonds)
DISTRICT 8	

Description:

Artist Janelle Stanley (AZ) has been commissioned to work with the Aviation Department, the Office of Arts and Culture, and the Automated Train team to design a terrazzo floor for the future train station platform and connector bridge at Sky Harbor Airport's Terminal 3. Approximately \$1,225,987 is expected to be spent or encumbered on this project in FY 2012/13. This project is programmed in FY 2013/14 and FY2014/15.

Project Title	<u>PSHIA Public Art Master Plan</u>
Project #	AR66000015
Location	Phoenix Sky Harbor International Airport
Type of Project	Master Planning
Funding Source	Aviation Capital Program
13-18 Budget	\$86,000 (non-GO bonds)
DISTRICT 8	

Description:

The POAC staff will work with the Aviation Department to develop a master plan to highlight the best way to advance the significant cultural offerings already enjoyed by Sky Harbor's more than 40 million passengers a year. The plan will outline opportunities for the development of future public art and Phoenix Airport Museum programming at the PSHIA. The plan will identify ideas and sites for integrated design, stand-alone installations and the development of long-term exhibition spaces and programs. Approximately \$2,323 is expected to be spent or encumbered on this project in FY 2012/13. This project is programmed in FY 2013/14.

Project Title	<u>PSHIA Terminal Redevelopments</u>
Project #	AR66000023
Location	Phoenix Sky Harbor International Airport
Type of Project	Design Team and Site-Specific Commissions
Funding Source	Aviation Capital Program
13-18 Budget	\$846,365 (non-GO Bonds)
DISTRICT 8	

Description:

Artists will be commissioned to work with the Aviation Department and its design team to enhance the design of future terminal redevelopments at PSHIA. POAC staff will work closely with the Aviation Department to take advantage of the opportunity to involve artists at the beginning of the design of future terminal redevelopments. This project is programmed in FY 2013/14 through FY 2015/16.

Project Title	<u>Public Works - 27th Avenue Solid Waste Management Facility</u>
Project #	AR70160001
Location	3060 South 27th Avenue (at Lower Buckeye Road)
Type of Project	Site-Specific Commission
Funding Sources	Solid Waste Capital Program
13-18 Budget	\$302,412 (non-GO)
DISTRICT 7	

Description:

An artist or artist led team will be commissioned to create artworks that welcome visitors to the 27th Avenue Solid Waste Management Facility while bolstering the Public Works Department's efforts citywide to create greater awareness about recycling and resource management. The artwork would enhance ongoing efforts to use the 27th Avenue Solid Waste Management Facility and other sites citywide to educate the community about recycling, sustainability and the City's role in providing waste management services for residents. Approximately \$323 is expected to be spent or encumbered on this project in FY 2012/13. This project is programmed in FY 2013/14 through FY 2015/16.

Project Title	<u>Pueblo Grande Entrance and Streetscape</u>
Project #	AR84850026
Location	44th Street and Washington Street
Type of Project	Design Team Commission
Funding Source	Water Capital Program
13-18 Budget	\$1,802,437 (non-GO Bonds)
DISTRICT 8	

Description:

Artist Brad Goldberg and the Arizona landscape architecture team of SmithGroup/JJR have been commissioned to work with the Pueblo Grande Museum, City departments and the community to design a new entrance and streetscape that significantly improves visitor connectivity to the light rail stop at 44th Street and Washington. Pueblo Grande Museum is a 102-acre site dedicated to the study and interpretation of the ancient Hohokam culture, including the network of ancient irrigation canals that were the forerunners of the modern water system supplying Phoenix. Improvement of the Grand Canal trail and 44th Street crossing south of the site could qualify for SRP Aesthetics funds and other non-City funds. Approximately \$50,000 is expected to be spent or encumbered on this project in FY 2012/13. This project is programmed in FY 2013/14 through FY 2014/15.

Project Title	<u>Rio Salado Enhancements</u>
Project #	AR74000008
Location	Various sites along Rio Salado
Type of Project	Design Team
Funding Source	Parks and Recreation Capital Program
13-18 Budget	\$117,053 (GO Bonds)
DISTRICT 7 & 8	

Description:

An Arizona artist or artist team will be selected to work with the City to identify opportunities to integrate artwork into the City's Rio Salado Habitat Restoration Project. This continues a project initiated in FY 2005-06. Due to changes in the Capital Improvement Program, this project is expected to be implemented in FY 2016/17.

Project Title	<u>Roosevelt Street Improvements</u>
Project#	AR63000026
Location	Roosevelt Street from Central Avenue to 7th Street
Type of Project	Design Team
Funding Source	Streets and Water Capital Programs
13-18 Budget	\$395,500 (non-GO Bonds)
DISTRICT 7 & 8	

Description:

Artist Meejin Yoon (MA) has been selected to work with the downtown community, the Street Transportation Department and the design team to create shade structures as part of the narrowing of Roosevelt Street between Central Avenue and 4th Street. The development of works will coincide with the narrowing the Roosevelt Street, to make room for wider sidewalks, street and pedestrian lighting, landscape and irrigation, site furnishing and shade structures, in accordance with the Roosevelt Row Design Guidelines for improvements along Roosevelt Street between 2nd Avenue and 7th Street. Approximately \$16,000 is expected to be spent or encumbered on this project in FY 2012/13. This project is programmed in FY 2013/14.

Project Title	<u>Skunk Creek Recreational Area</u>
Project #	AR70100007
Location	Skunk Creek Landfill
Type of Project	Design Team
Funding Source	Solid Waste Capital Program
13-18 Budget	\$81,060 (non-GO Bonds)
DISTRICT 1	

Description:

This project will provide an opportunity for an Arizona artist to participate in the design of passive recreational elements, such as trails and open space, at the Skunk Creek Landfill and to identify additional public art opportunities at the site. This continues project begun in FY 2004-05. This project is programmed in FY 2014/15 and FY 2015/16.

Project Title **Sonoran Boulevard**
Project # **AR63000015**
Location **Sonoran Park Preserve**
Type of Project **Design Team Commission**
Funding Source **Streets Capital Program**
13-18 Budget **\$10,000 (non-GO Bonds)**
DISTRICT 2

Description:

The artist team of Rosario Marquardt and Roberto Behar (FL) was commissioned to work with an engineering design team, City departments and the community to design enhancements for the bridges and trail connections along the Sonoran Boulevard. The project was substantially completed in FY 2012/13. Approximately \$3,000 is expected to be spent or encumbered on this project in FY 2012/13. The project is expected to be closed out in FY 2013/14.

Project Title **South Mountain Library/Western Canal**
Project # **AR75000005**
Location **24th Street and Western Canal**
Type of Project **Site-Specific Commission**
Funding Source **Library Capital Program**
12-17 Budget **\$70,000 (GO Bonds)**
DISTRICT 8

Description:

As part of this award-winning project, the artist team of Mags Harries (MA), Lajos Heder (MA) and Christy Ten Eyck (AZ) engaged Arizona poet Alberto Rios to work with the community to write a community poem about the South Mountain area. This final phase of the project will commission an Arizona filmmaker to document Rios' work with residents to create the poem, *Baseline Blooms*, and to produce a web-based or printed monograph of poems for the Phoenix Library that have been produced through the City's public art program projects. Approximately \$856 is expected to be spent or encumbered on this project in FY 2012/13. This project is scheduled for closeout in FY 2013/14.

Project Title **Southwest Family Service Center**
Project # **AR89000003**
Location **51st Avenue and Lower Buckeye Road**
Type of Project **Site-Specific Commission**
Funding Source **Human Services and Wastewater Capital Programs**
13-18 Budget **\$87,263 (\$57,263 GO; \$30,000 non-GO Bonds)**
DISTRICT 7

Description:

Arizona Artist Shona Patel has been commissioned to design the terrazzo floor at the new South Family Service Center at 51st Avenue and Lower Buckeye Road. Due to changes in the Capital Improvement Program, this project is expected to be implemented in FY 2016/17.

Project Title	<u>SR51 Artwork Refurbishment</u>
Project #	AR39000002
Location	Sites along SR51 between McDowell Road and 32nd Street
Type of Project	Artwork Refurbishment
Funding Source	Freeway Mitigation Capital Program
13-18 Budget	\$178,565 (\$57,404 GO; \$121,161 non-GO Bonds)
CITYWIDE	

Description:

This project will commission and Arizona artist and contractor to carry out a major renovation of large public artworks created for SR 51. The works, completed in the early 1990s need to be refurbished due to their exposure to the elements and damage by vandals. Due to changes in the Capital Improvement Program, this project is expected to be implemented in FY 2016/17.

Project Title	<u>Street Views</u>
Project #	AR63000027
Location	Various
Type of Project	Site-Specific Changing Exhibit
Funding Sources	Streets Capital Program
13-18 Budget	\$34,557 (GO Bonds)
CITYWIDE	

Description:

The Phoenix Office of Arts and Culture will work with the Street Transportation Department to develop a program of rotating displays of sculpture and other 3-dimensional works by Arizona artists at under-utilized or vacant spaces along City streets. This would include locations built for this purpose at highly visible sites in the City. This project will give Arizona artists the same opportunity to compete and exhibit 3-dimensional works that the 7th Avenue Streetscape Public Art Project has provided to artists specializing in 2-dimensional media. Due to changes in the Capital Improvement Program, this project is expected to be implemented in FY 2016/17.

Project Title	<u>Thomas Road Overpass Artwork Refurbishment</u>
Project #	AR63000028
Location	Thomas Road and SR 51
Type of Project	Artwork Refurbishment
Funding Source	Streets Capital Program
13-18 Budget	\$50,000 (non-GO Bonds)
DISTRICTS 4 & 8	

Description:

Arizona artist Marilyn Zwak has been commissioned to carry out a major restoration of the adobe wall panels integrated into the SR 51 overpass at Thomas Road. Portions of the panels that Zwak produced through a collaboration with community residents in 1990, have been damaged by vandals and exposure to the elements. The Thomas Road Overpass was the first of the City's many award-winning public art projects created by design teams. Approximately \$963 is expected to be spent or encumbered on this project in FY 2012/13. This project is scheduled to be completed in FY 2013/14.

Project Title	<u>Tres Rios Wetlands</u>
Project #	AR84900010
Location	91st Avenue and Baseline Road
Type of Project	Design Team Commission
Funding Source	Wastewater Capital Program
13-18 Budget	\$20,000 (non-GO Bonds)
DISTRICT 7	

Description:

Artist Adam Kuby (OR) has been commissioned to work as part of a design team with City departments, consultants and the community to create significant recreation and education opportunities as part of this multi-year effort to improve the 7-mile, 1500-acre wetland at the confluence of the Salt and Gila Rivers, in southwestern Phoenix. The project consists of a flood protection levee, effluent pump station, emergent wetlands, and riparian corridors and open water marsh areas to replace existing non-native salt cedar in the river. The primary goals are flood protection for the local residents and habitat restoration for the native animals. Approximately \$10,000 is expected to be spent or encumbered on this project in FY 2012/13. This project is programmed in FY 2013/14.

Project Title	<u>Washington Park Tennis Center</u>
Project #	AR84850028
Location	6330 North 21st Avenue
Type of Project	Site-Specific
Funding Source	Water Capital Program
13-18 Budget	\$242,000 (non-GO Bonds)
DISTRICT 5	

Description:

An artist will be selected to work with the community, the tennis center and City departments to create a new entry and fences for this key site. This project would improve the access to and visibility of the Phoenix Tennis Center, which is adjacent to the Washington Activity Complex. The Center has 39 lighted courts, hosting approximately 40 major tournaments and 50,000 tennis players a year. This project is programmed in FY 2014/15 and FY 2015/16.

Project Title	<u>Water Public Art Plan</u>
Project #	AR84850013
Location	Citywide
Type of Project	Master Planning
Funding Source	Wastewater Capital Program
13-18 Budget	\$7,780 (non-GO Bonds)
CITYWIDE	

Description:

A comprehensive computerized mapping system (GIS mapping) will be developed to enable staff to determine the best sites and opportunities Citywide for future public art projects using water and wastewater percent-for-art funds. The mapping system will help to identify key opportunities to cluster public art funds and projects, increasing the public benefits of integrating art with the design of City buildings, parks, streetscapes and other public spaces. The initial planning map was developed in FY 2006/07. This project will enable City staff to refine the ongoing mapping of City projects and more efficiently integrate art into City capital improvement projects in the next five years. Approximately \$3,000 is expected to be spent or encumbered on this project in FY 2012/13. This project is programmed in FY 2013/14.

2013-18 PUBLIC ART PROJECT PLAN MAJOR MULTI-YEAR PROJECTS

Completion of the following projects will require significant funding resources over the next five fiscal years. Funding for the planning and implementation of these projects is included in the 2013-18 Public Art Project Plan. Funding of all projects is subject to City Council approval through future Public Art Project Plans.

Arterial Canal Crossings - Artist teams will be selected to work with the community, multiple City departments and the Salt River Project to improve the safety and connectivity of major street and trail crossings along the Grand Canal through central Phoenix. The Grand Canal's trail system could provide a bicycle- and walker-friendly corridor linking neighborhoods and amenities in central Phoenix to such landmarks as Pueblo Grande, Phoenix Sky Harbor, and Valley Metro Light Rail.

Light Rail Corridors

Artists will be selected to work with the community, City Departments and Valley Metro to develop integrated public art streetscape projects in conjunction with the construction of the future Light Rail corridors along 19th Avenue. The projects would extend the City's effort to create shaded streetscapes, sidewalks, and improved transit connections Citywide.

Major Street Improvements

In addition to the enhancements being carried out in the Isaac neighborhood, artists will be involved in the design of other major streets retrofits in the coming years, including Avenida Rio Salado (Broadway Road) and Sonoran Boulevard. For the Sonoran project, the artist team of Rosario Marquardt and Roberto Behar has worked with community representatives and the project design team to develop enhancements that will enhance trail connections and three of the bridges along the planned boulevard.

Public Works Recycling and Sustainability Initiative

Photographer Paho Mann (TX), has been commissioned to develop an interactive digital program of images to strengthen the City's educational efforts to create greater awareness of the need for recycling and sustainable resource management. Mann's interactive web site and kiosks for transfer station visitors - completed in completed in FY 2011-12, is the first in a series of projects designed to involve artists in promoting greater public awareness about sustainable resource-management practices.

PSHIA PHX Sky Train and Aviation Terminal Expansion Public Art Projects – The Phoenix Sky Harbor International Airport Phx Sky Train, which opened in 2013, and future terminal expansions, represent the City's most significant opportunity to reach the widest public with great public art and integrated design. PSHIA handles more than 40 million passengers. The Automated Train will carry travelers between the airport terminals, remote parking facilities; the Rental Car Center and the METRO light rail station at 44th Street and Washington. Public Art staff is working with Aviation staff and its design teams to carry out a comprehensive plan for incorporating significant art and design to enhance the experience of travelers. Projects will be implemented as the airport expansion and train are phased in. The Office of Arts and Culture will select artists to work with the Aviation Department and consultants to develop art projects for future airport expansions.

Tres Rios Wetlands

Artist Adam Kuby has been commissioned to work with City departments, consultants and the community to create significant recreation and education opportunities as part of this multi-year effort to improve the 7-mile, 1500-acre wetland at the confluence of the Salt and Gila Rivers, in southwestern Phoenix.

2013-18 PUBLIC ART PROJECT PLAN SUBSTANTIALLY COMPLETED PROJECTS

Substantially Completed Projects

Artist

7 th Avenue Streetscape	Four poets (AZ)
Fire Training Academy Entrance	Tyson Snow (AZ/UT)
Fire Training Academy Terrazzo	Tyson Snow (AZ/UT)
Lift Station #53 at Las Palmaritas	coLAB (AZ)
Matthew Henson/HOPE VI	John Randall Nelson (AZ) and Joe Willie Smith (AZ)
PHX Sky Train Terminal 4 Bridges	Daniel Mayer (AZ)
PHX Sky Train 44 th St. Station Inter.	Mario Madayag (WA), Michael Parekowhai (NZ) and Paul Deeb
PHX Sky Train 44 th St. St. Ped Bridge	Daniel Martin Diaz (AZ)
PHX Sky Train 44 th St Station Platform	Fausto Fernandez (AZ)
PHX Sky Train Terminal 4 Station Platform	Daniel Mayer (AZ)
PHX Sky Train EEL Station	Anne Coe (AZ)
Reach 11 Recreation Enhancements	Yang Chyi Lee (TX)

The 12 capital projects finished in FY 2012-13 brings to 177 the number of public art projects completed by the Phoenix Office of Arts and Culture since the public art program began in 1986. Seven projects are expected to be completed in FY 2013-14.

Discontinued Projects

With the concurrence of the respective funding departments, the Office has determined that, for various reasons, the following project in the FY 2012-17 Public Art Project Plan can not be implemented and should not be carried forward to FY 2013-18:

11th Street Streetscape

2013-18 PUBLIC ART PROJECT PLAN SUMMARY

Number of New Projects	3	Budget	\$278,000
Number of Continuing Projects	57	Budget	\$9,714,909
Total Number of Projects	60		
Total 2013-18 Public Art Project Plan Budget			\$9,992,909

Arizona Artists

Of the 51 projects identified in the 2013-18 Public Art Project Plan that are expected to involve commissioning artists and contractors, at least 29 (57 %) are expected to involve artists or teams with an Arizona member. Nine projects are not expected to entail commissioning artists and designers. They involve long-range planning and other initiatives. Artists who live in Arizona are eligible and encouraged to apply for all projects.

Index by Council District

Council District

Project Description

DISTRICT 1

Deer Valley WTP Wall and Streetscape
Pioneer Living Heritage Village
Skunk Creek Recreational Area

DISTRICT 1, 2

Fire Station #55

DISTRICT 2

56th Street Reservoir Streetscape
North Transfer Station Recycling Phase III
Pinnacle Peak Water Reservoir

DISTRICT 3

North 32nd Street Improvement
Hatcher Road Streetscape
Police Precinct Station on Greenway Road

DISTRICT 4

7th Avenue at Melrose Curve
Grand Canal at Central Avenue
Isaac Streetscape II
Park at 32nd Avenue & McDowell Road

DISTRICT 4, 8

Thomas Road Overpass Artwork Refurbishment

DISTRICT 5

107th Avenue Streetscape
La Pradera Park
Light Rail Corridor
Washington Park Tennis Center

DISTRICT 5, 7

67th Avenue Bus Shelters & Streetscape
Desert Sky Transit Center

Council District

Project Description

DISTRICT 6

16th Street & Bethany Home Road Streetscape
Arizona Falls
Fire Station #74
Police Precinct Station #700

DISTRICT 7

Downtown Civic Space
Kuban Park
Public Works 27th Avenue Solid Waste Management Facility
Southwest Family Service Center
Tres Rios Wetlands

DISTRICT 7, 8

Artists Initiative V Temporary Projects
Avenida Rio Salado/Broadway Rd Streetscape
Connected Oasis
Gimme Shelter Urban Shade
Rio Salado Enhancements
Roosevelt Streetscape

DISTRICT 8

24th Street & Baseline Road Park & Ride
32nd Street Retrofit and Grand Canal
Aviation Portable Works Collection
Bola Tie Installation on Washington Street
Buckeye Road Streetscape
Harmon Branch Library
Highline Canal at Circle K Park
Matthew A Henson/Hope VI Housing Project
Phoenix Biomedical Campus
PSHIA PHX SkyTrain
PSHIA Phx SkyTrain Terminal 3 Station Platform
PSHIA Phx SkyTrain 44th Street Station Interior
PSHIA Public Art Master Plan
PSHIA Terminal Redevelopments
Pueblo Grande Museum
South Mountain Library / Western Canal

Council District	Project Description
CITYWIDE	Arterial Canal Crossings Cultural Voices--Arizona Artists Historic Phoenix Landmarks II Lift Station Projects SR51 Artwork Refurbishment Street Views Water Public Art Plan

Index by Funding Program

Funding Program	Project Description	Total Budget 13-18
Aviation		
<u>Phase</u>		
Planning	Aviation Portable Works Collection	120,000
Planning	PSHIA PHX SkyTrain	30,000
Closeout	PSHIA PHX SkyTrain 44 th St. Station Interior	12,765
Design/Construction	PSHIA PHX SkyTrain Terminal 3 Station	50,185
Planning	PSHIA Terminal Redevelopments	846,365
Planning	PSHIA Public Art Master Plan	86,000
	Program Total	1,145,315
Cultural Facilities		
<u>Phase</u>		
Design	Phoenix Biomedical	3,600
Planning	Pioneer Living Heritage Village	1,100
	Program Total	4,700
Economic Development		
<u>Phase</u>		
Construction	67th Avenue Bus Shelters & Streetscape	18,000
Design	Phoenix Biomedical Campus	229,004
Construction	Gimme Shelter Shade	6,400
	Program Total	253,404
Fire Protection		
<u>Phase</u>		
Planning	Fire Station #55	107,000

2013-18 Public Art Project Plan

Page 40

Funding Program	Project Description	Total Budget 13-18
<u>Phase</u>		
Planning	Fire Station #74	120,000
	Program Total	227,000
Freeway Mitigation		
<u>Phase</u>		
Planning	SR51 Artwork Refurbishment	178,565
	Program Total	178,565
Historic Preservation		
<u>Phase</u>		
Closeout	Historic Phoenix Landmarks II	2,121
	Program Total	2,121
Human Services		
<u>Phase</u>		
Design	Southwest Family Service Center	57,263
	Program Total	57,263
Library Facilities		
<u>Phase</u>		
Planning	Cultural Voices--Arizona Artists	40,000
Construction	Harmon Branch Library	35,000
Construction	South Mountain Library / Western Canal	70,000
	Program Total	145,000
Neighborhood Services		
<u>Phase</u>		
Design	16th Street & Bethany Home Road Streetscape	35,060
Design	Hatcher Road Streetscape	75,000
Planning	Historic Phoenix Landmarks II	8,993
	Program Total	119,053

2013-18 Public Art Project Plan

Page 41

Funding Program	Project Description	Total Budget 13-18
Parks and Recreation		
<u>Phase</u>		
Design/Construction	Artists' Initiative V Temporary Projects	17,307
Design	Phoenix Biomedical	25,000
Planning	Pioneer Living Heritage Village	118,900
Planning	Rio Salado	117,053
	Program Total	278,260
Police Protection		
<u>Phase</u>		
Planning	Police Precinct Station #700	230,179
Planning	Police Precinct Station on Greenway Road	186,780
	Program Total	416,959
Public Transit		
<u>Phase</u>		
Design	24th Street & Baseline Road Park & Ride	51,000
<i>Planning/Design</i>	<i>Desert Sky Transit Center</i>	<i>20,000</i>
	Program Total	71,000
Solid Waste Disposal		
<u>Phase</u>		
Planning	North Transfer Station Recycling Phase III	85,000
Planning	Public Works 27th Avenue Solid Waste	302,412
Planning	Skunk Creek Recreational Area	81,060
Design	7th Avenue at Melrose	59,160
	Program Total	527,632

2013-18 Public Art Project Plan

Page 42

Funding Program	Project Description	Total Budget 13-18
Storm Sewers		
<u>Phase</u>		
Design	Highline Canal at Circle K Park	10,000
	Program Total	10,000
Street Improvements		
<u>Phase</u>		
Design	16th Street & Bethany Home Road Streetscape	1,059
<i>Planning</i>	<i>North 32nd Street Improvements</i>	<i>158,000</i>
Planning	32 nd Street Retrofit and Grand Canal	50,000
Construction	67th Avenue Bus Shelters & Streetscape	70,000
<i>Planning</i>	<i>107 Avenue Streetscape</i>	<i>100,000</i>
Planning	Arterial Canal Crossings	122,857
Design	Avenida Rio Salado/Broadway Rd Streetscape	146,000
Planning	Buckeye Road Streetscape	107,000
Construction	Gimme Shelter Urban Shade	440,000
Design	Hatcher Road Streetscape	63,634
Design	Phoenix Biomedical	117,001
Design	Roosevelt Street Improvements	215,500
Construction	Sonoran Boulevard	10,000
Planning	Street Views	34,557
Construction	Thomas Road Overpass Artwork Refurbishment	50,000
	Program Total	1,685,608
Wastewater		
<u>Phase</u>		
Construction	Artists Initiative V Temporary Projects	37,110
Design	Avenida Rio Salado/Broadway Road Streetscape	605,062
Design	Bola Tie Installation on Washington Street	35,000
Closeout	Downtown Civic Space	13,791
Planning	Isaac Streetscape II	65,000
Design	Kuban Park	29,000
Planning	La Pradera Park	257,880
Planning	Lift Station Projects	122,908
Design	Light Rail Corridor	250,000
Design	Southwest Family Service Center	30,000
Planning	Park at 32 nd Avenue & McDowell Road	204,234
Design	Tres Rios Wetlands	20,000

2013-18 Public Art Project Plan

Page 43

Funding Program	Project Description	Total Budget 13-18
Wastewater		
Planning	Water Public Art Plan	7,780
	Program Total	1,677,765
Water		
<u>Phase</u>		
Planning	32 nd Street Retrofit	3,115
Planning	56th Street Reservoir Streetscape	100,000
Planning	Arizona Falls	35,200
Planning	Arterial Canal Crossings	224,700
Design	Connected Oasis	60,000
Design	Deer Valley WTP Wall and Streetscape	233,000
Construction	Gimme Shelter Urban Shade	68,968
Design	Grand Canal at Central Avenue	105,000
Closeout	Matthew Henson HOPE VI	10,000
Design	Phoenix Biomedical	12,844
Construction	Pinnacle Peak Water Reservoir	116,000
Design	Pueblo Grande Entrance & Streetscape	1,802,437
Design	Roosevelt Street Improvement	180,000
Planning	Washington Park Tennis Center	242,000
	Program Total	3,193,264
	Grand Total	9,992,909

2013-18 Public Art Plan Budget

<i>Project Description</i>	<i>13-14</i>	<i>14-15</i>	<i>15-16</i>	<i>16-17</i>	<i>17-18</i>	<i>Total</i>
<i>Project #</i>	<i>Budget</i>	<i>Budget</i>	<i>Budget</i>	<i>Budget</i>	<i>Budget</i>	<i>13-18</i>
107th Avenue Streetscape						
AR63000031						
0007 AHUR 30% Street Imp.	100,000	0	0	0	0	100,000
	100,000	0	0	0	0	100,000
16th Street & Bethany Home Rd Streetscape						
AR63000020						
3380 2006 GO NSD-% Arts	35,060	0	0	0	0	35,060
3384 2006 GO Street Imprv	1,059	0	0	0	0	1,059
	36,119	0	0	0	0	36,119
24th St & Baseline Park & Ride						
AR67000009						
1204 Public Transit T2000	51,000	0	0	0	0	51,000
	51,000	0	0	0	0	51,000
27th Ave Solid Waste						
AR70160001						
65909 Solid - Mega IV	111,352	166,060	25,000	0	0	302,412
	111,352	166,060	25,000	0	0	302,412
32nd St Retrofit and Grand Canal						
AR84850023						
1421 2008 CIC Wtr Bonds	3,115	0	0	0	0	3,115
3384 2006 GO Street Imprv	0	0	0	0	50,000	50,000
	3,115	0	0	0	50,000	53,115
56th St Water Reservoir Streetscape						
AR84850027						
1421 2008 CIC Wtr Bonds	0	0	25,000	75,000	0	100,000
	0	0	25,000	75,000	0	100,000
67th Ave Bus Shelters & Streetscape						
AR67000006						
0007 AHUR 30% Street Imp.	0	0	0	0	0	0
1204 Public Transit T2000	0	0	0	0	0	0
3376 2006 GO Econ Develop	0	0	0	0	18,000	18,000
3384 2006 GO Street Imprv	0	0	0	0	70,000	70,000
	0	0	0	0	88,000	88,000

2013-18 Public Art Project Plan

Page 45

Project Description Project #	13-14 Budget	14-15 Budget	15-16 Budget	16-17 Budget	17-18 Budget	Total 13-18
7th Avenue at Melrose Curve						
AR63000025						
0007 AHUR 30% Street Imp.	0	0	0	0	0	0
65909 Solid - Mega IV	19,160	20,000	20,000	0	0	59,160
	19,160	20,000	20,000	0	0	59,160
Arizona Falls						
AR84850019						
1421 2008 CIC Wtr Bonds	0	0	35,200	0	0	35,200
	0	0	35,200	0	0	35,200
Arterial Canal Crossings & Trail Connections						
AR63000013						
0007 AHUR 30% Street Imp.	107,857	15,000	0	0	0	122,857
1421 2008 CIC Wtr Bonds	0	74,700	150,000	0	0	224,700
	107,857	89,700	150,000	0	0	347,557
Artists Initiative V Temporary Projects						
AR74000014						
1421 2008 CIC Wtr Bonds	0	0	0	0	0	0
1366 2006 CIC WW Bonds	37,110	0	0	0	0	37,110
1420 2008 CIC WW Bonds	0	0	0	0	0	0
3366 2006 GO Parks-% Arts	17,307	0	0	0	0	17,307
	54,417	0	0	0	0	54,417
Audubon Center/Rio Salado Enhancements						
AR74000008						
3310 2001 GO RioSalR-%Art	0	0	0	0	77,710	77,710
3312 2001 GO RioSalFC%Art	0	0	0	0	39,343	39,343
	0	0	0	0	117,053	117,053
Avenida Rio Salado/Broadway Road Streetscape						
AR84900008						
1366 2006 CIC WW Bonds	595,062	10,000	0	0	0	605,062
3384 2006 GO Street Imprv	0	0	0	0	46,000	46,000
0007 AHUR 30% Street Imp.	100,000	0	0	0	0	100,000
	695,062	10,000	0	0	46,000	751,062
Aviation Public Art						
AR66000015						
1528 2010A Arpt Rev Bonds	86,000	0	0	0	0	86,000
	86,000	0	0	0	0	86,000

2013-18 Public Art Project Plan

Page 46

<i>Project Description Project #</i>	<i>13-14 Budget</i>	<i>14-15 Budget</i>	<i>15-16 Budget</i>	<i>16-17 Budget</i>	<i>17-18 Budget</i>	<i>Total 13-18</i>
Bola Tie Relocation						
AR84900006						
1366 2006 CIC WW Bonds	20,000	0	15,000	0	0	35,000
	20,000	0	15,000	0	0	35,000
Buckeye Road Streetscape						
AR63000023						
0007 AHUR 30% Street Imp.	50,000	0	34,497	0	0	84,497
3384 2006 GO Street Imprv	0	0	0	0	22,503	22,503
	50,000	0	34,497	0	22,503	107,000
Connected Oasis						
AR84850012						
1421 2008 CIC Wtr Bonds	60,000	0	0	0	0	60,000
1366 2006 CIC WW Bonds	0	0	0	0	0	0
	60,000	0	0	0	0	60,000
Cultural Voices-Arizona Artists						
AR75000006						
3374 2006 GO LIB-% Arts	0	0	0	0	40,000	40,000
	0	0	0	0	40,000	40,000
Desert Sky Transit Center						
AR67000010						
1204 Public Transit T2000	20,000	0	0	0	0	20,000
	20,000	0	0	0	0	20,000
Downtown Civic Space LR Conctr						
AR67000003						
1366 2006 CIC WW Bonds	13,791	0	0	0	0	13,791
1420 2008 CIC WW Bonds	0	0	0	0	0	0
	13,791	0	0	0	0	13,791
Fire Station #55						
AR57000007						
3356 2006 GO Fire Protect	0	0	0	0	107,000	107,000
	0	0	0	0	107,000	107,000

2013-18 Public Art Project Plan

Project Description Project #	13-14 Budget	14-15 Budget	15-16 Budget	16-17 Budget	17-18 Budget	Total 13-18
Fire Station #74						
AR57000009						
3320 2001 GO FirePro-%Art	0	0	0	0	103,000	103,000
3356 2006 GO Fire Protect	0	0	0	0	17,000	17,000
	0	0	0	0	120,000	120,000
Gimme Shelter Shade						
AR84850025						
0007 AHUR 30% Street Imp.	440,000	0	0	0	0	440,000
1421 2008 CIC Wtr Bonds	68,968	0	0	0	0	68,968
3364 2006 GO Downtown Edu	6,400	0	0	0	0	6,400
	515,368	0	0	0	0	515,368
Grand Canal at Central Avenue						
AR84850010						
1421 2008 CIC Wtr Bonds	0	5,000	100,000	0	0	105,000
	0	5,000	100,000	0	0	105,000
Harmon Branch Library						
AR75000004						
3374 2006 GO LIB-% Arts	35,000	0	0	0	0	35,000
	35,000	0	0	0	0	35,000
Hatcher Rd Streetscape						
AR63000021						
3380 2006 GO NSD-% Arts	75,000	0	0	0	0	75,000
3384 2006 GO Street Imprv	63,634	0	0	0	0	63,634
	138,634	0	0	0	0	138,634
Highline Canal at Circle K Park – PH II						
AR63000024						
3382 2006 GO Storm Sewer	10,000	0	0	0	0	10,000
	10,000	0	0	0	0	10,000
Historic Phoenix Landmarks II						
AR46000003						
3364 2006 GO Downtown Edu	2,121	0	0	0	0	2,121
3380 2006 GO NSD-% Arts	8,993	0	0	0	0	8,993
	11,114	0	0	0	0	11,114

2013-18 Public Art Project Plan

Page 48

Project Description Project #	13-14 Budget	14-15 Budget	15-16 Budget	16-17 Budget	17-18 Budget	Total 13-18
Isaac Streetscape Phase II						
AR84900012						
1366 2006 CIC WW Bonds	0	65,000	0	0	0	65,000
	0	65,000	0	0	0	65,000
Issac Park (AKA Park at 32nd Ave. & McDowell Rd)						
AR74000010						
1366 2006 CIC WW Bonds	0	0	50,000	154,234	0	204,234
	0	0	50,000	154,234	0	204,234
Kuban Park Phase II						
AR74000011						
1366 2006 CIC WW Bonds	29,000	0	0	0	0	29,000
3366 2006 GO Parks-% Arts	0	0	0	0	0	0
	29,000	0	0	0	0	29,000
La Pradera Park						
AR74000012						
1366 2006 CIC WW Bonds	0	25,000	232,880	0	0	257,880
	0	25,000	232,880	0	0	257,880
Lift Station Projects						
AR84900011						
1366 2006 CIC WW Bonds	0	0	122,908	0	0	122,908
	0	0	122,908	0	0	122,908
Light Rail Corridor						
AR63000014						
1366 2006 CIC WW Bonds	0	61,120	150,000	38,880	0	250,000
1420 2008 CIC WW Bonds	0	0	0	0	0	0
	0	61,120	150,000	38,880	0	250,000
Master Water Art Plan						
AR84850013						
1366 2006 CIC WW Bonds	7,780	0	0	0	0	7,780
	7,780	0	0	0	0	7,780
Matthew A. Henson/HOPE VI						
AR88000005						
1421 2008 CIC Wtr Bonds	10,000	0	0	0	0	10,000
3378 2006 GO HSG-% Arts	0	0	0	0	0	0
3384 2006 GO Street Imprv	0	0	0	0	0	0
	10,000	0	0	0	0	10,000

2013-18 Public Art Project Plan

Page 49

Project Description Project #	13-14 Budget	14-15 Budget	15-16 Budget	16-17 Budget	17-18 Budget	Total 13-18
North 32nd Street Improvement						
AR63000030						
0007 AHUR 30% Street Imp.	100,000	0	0	0	0	100,000
3384 2006 GO Street Imprv	58,000	0	0	0	0	58,000
	158,000	0	0	0	0	158,000
North Transfer Station Recycling PH III						
AR70000003						
65909 Solid - Mega IV	30,000	20,000	20,000	15,000	0	85,000
	30,000	20,000	20,000	15,000	0	85,000
Phoenix Biomedical Campus						
AR87000007						
1421 2008 CIC Wtr Bonds	12,844	0	0	0	0	12,844
3364 2006 GO Downtown Edu	0	0	0	0	168,404	168,404
3366 2006 GO Parks-% Arts	0	0	0	0	25,000	25,000
3368 2006 GO Arts&CultFac	0	0	0	0	3,600	3,600
3376 2006 GO Econ Develop	0	0	0	0	60,600	60,600
3384 2006 GO Street Imprv	0	0	0	0	117,001	117,001
	12,844	0	0	0	374,605	387,449
Pinnacle Peak Water Reservoir						
AR84850024						
1421 2008 CIC Wtr Bonds	116,000	0	0	0	0	116,000
	116,000	0	0	0	0	116,000
Pioneer Living Heritage Museum						
AR74000015						
3366 2006 GO Parks-% Arts	0	0	0	0	118,900	118,900
3368 2006 GO Arts&CultFac	0	0	0	0	1,100	1,100
	0	0	0	0	120,000	120,000
Police Precinct Station on Greenway Road						
AR48000006						
3358 2006 GO PPD Protect	0	0	0	0	186,780	186,780
	0	0	0	0	186,780	186,780
Police Sub-Station #700						
AR48000007						
3358 2006 GO PPD Protect	0	0	0	0	221,179	221,179
3362 2006 GO Tech-% Arts	0	0	0	0	9,000	9,000
	0	0	0	0	230,179	230,179

2013-18 Public Art Project Plan

Page 50

<i>Project Description Project #</i>	<i>13-14 Budget</i>	<i>14-15 Budget</i>	<i>15-16 Budget</i>	<i>16-17 Budget</i>	<i>17-18 Budget</i>	<i>Total 13-18</i>
PSHIA PHX SkyTrain at 44th St Station Interior						
AR66000029						
1528 2010A Arpt Rev Bonds	12,765	0	0	0	0	12,765
	12,765	0	0	0	0	12,765
PSHIA PHX SkyTrain at T-3 Station						
AR66000025						
1528 2010A Arpt Rev Bonds	35,185	15,000	0	0	0	50,185
	35,185	15,000	0	0	0	50,185
PSHIA PHX SkyTrain						
AR66000022						
1528 2010A Arpt Rev Bonds	15,000	15,000	0	0	0	30,000
	15,000	15,000	0	0	0	30,000
PSHIA Portable Works						
AR66000021						
1528 2010A Arpt Rev Bonds	30,000	30,000	30,000	30,000	0	120,000
	30,000	30,000	30,000	30,000	0	120,000
PSHIA Terminal Expansion						
AR66000023						
1426	0	636,018	210,347	0	0	846,365
1528	0	0	0	0	0	0
	0	636,018	210,347	0	0	846,365
Pueblo Grande Museum						
AR84850026						
1421 2008 CIC Wtr Bonds	1,782,437	20,000	0	0	0	1,802,437
3366 2006 GO Parks % for Arts	0	0	0	0	0	0
	1,782,437	20,000	0	0	0	1,802,437
Roosevelt Street Improvements						
AR63000026						
0007 AHUR 30% Street Imp.	215,500	0	0	0	0	215,500
1421 2008 CIC Wtr Bonds	180,000	0	0	0	0	180,000
	395,500	0	0	0	0	395,500

2013-18 Public Art Project Plan

Page 51

Project Description Project #	13-14 Budget	14-15 Budget	15-16 Budget	16-17 Budget	17-18 Budget	Total 13-18
Skunk Creek Recreational Area						
AR70100007						
65909 Solid - Mega IV	0	40,000	41,060	0	0	81,060
	0	40,000	41,060	0	0	81,060
Sonoran Parkway Boulevard						
AR63000015						
0007 AHUR 30% Street Imp.	10,000	0	0	0	0	10,000
	10,000	0	0	0	0	10,000
South Mountain Library/Western Canal						
AR75000005						
1421 2008 CIC Wtr Bonds	0	0	0	0	0	0
3374 2006 GO LIB-% Arts	70,000	0	0	0	0	70,000
	70,000	0	0	0	0	70,000
Southwest Family Service Center						
AR89000003						
1366 2006 CIC WW Bonds	0	0	0	30,000	0	30,000
3324 2001 GO Sr/Fam-%Art	0	0	0	0	40,170	40,170
3370 2006 GO HSD-% Arts	0	0	0	0	17,093	17,093
	0	0	0	30,000	57,263	87,263
SR51 Artwork Refurbishment						
AR39000002						
0176 1988 Freewy Mit Bnds	0	0	0	0	121,161	121,161
3340 2001 GO FrwyMit-%Art	0	0	0	0	57,404	57,404
	0	0	0	0	178,565	178,565
Street Views						
AR63000027						
0007 AHUR 30% Street Imp.	0	0	0	0	0	0
3384 2006 GO Street Imprv	0	0	0	0	34,557	34,557
	0	0	0	0	34,557	34,557
Thomas Road Overpass Refurbishment						
AR63000028						
0007 AHUR 30% Street Imp.	50,000	0	0	0	0	50,000
	50,000	0	0	0	0	50,000

2013-18 Public Art Project Plan

Page 52

<i>Project Description Project #</i>	<i>13-14 Budget</i>	<i>14-15 Budget</i>	<i>15-16 Budget</i>	<i>16-17 Budget</i>	<i>17-18 Budget</i>	<i>Total 13-18</i>
Tres Rios Wetlands						
AR84900010						
1366 2006 CIC WW Bonds	20,000	0	0	0	0	20,000
	20,000	0	0	0	0	20,000
Wall Art at Deer Valley						
AR84850018						
1421 2008 CIC Wtr Bonds	233,000	0	0	0	0	233,000
	233,000	0	0	0	0	233,000
Washington Park Tennis Center						
AR84850028						
1421 2008 CIC Wtr Bonds	0	35,000	207,000	0	0	242,000
	0	35,000	207,000	0	0	242,000
Totals	\$5,155,500	\$1,252,898	\$1,468,892	\$343,114	\$1,772,505	\$9,992,909