

Agenda

- Introduction
- History
- Need and Purpose
- Layout (Central to 4th Street)
- Landscape/Hardscape/Street Furniture
- Schedule
- Art Component



THANK YOU

A special thank you to all those who have supported this project from the beginning to the end. Your contributions have made this project possible and we are grateful for your support.

SPECIAL THANKS TO:

RITICH POWELL & ASSOCIATES
 CIVIL ENGINEERING & SURVEYING CONSULTANTS
 1000 N. CENTRAL AVENUE, SUITE 100
 DENVER, CO 80202
 PH: 303.733.1111
 WWW.RITICHP.COM

PROJECT MANAGER: [Name]
 DESIGNER: [Name]
 SURVEYOR: [Name]
 CIVIL ENGINEER: [Name]
 SURVEYING ENGINEER: [Name]

CLIENT: [Name]
 ADDRESS: [Address]
 CITY: [City]
 STATE: [State]
 ZIP: [ZIP]

CONTRACT NO.: [Number]
 DATE: [Date]

RITICH POWELL & ASSOCIATES
 CIVIL ENGINEERING & SURVEYING CONSULTANTS

Timeline History of Roosevelt Row Design

- **Street Transportation Department restripes Roosevelt Street at a request of neighborhood, 2005**
- **MAG DESIGN ASSISTANCE PROJECT**
 - Public Meetings: May 4, October 5, November 21, and December 19, 2006
 - Roosevelt Row Pedestrian Enhancement Project Final Report: January 2006
- **ROOSEVELT ROW DESIGN GUIDELINES**
 - Public Meetings: January 25, March 2, April 6, and September 29, 2010
 - Roosevelt Row Design Guidelines, April 2011

Timeline History of Roosevelt Row Design (cont.)

■ TRANSPORTATION ENHANCEMENT GRANT

- Submittals: April 21, May 13, and August 4, 2010
- Transportation Enhancement grant awarded in December 2, 2010

■ Environmental Clearance Process: September 2011 – August 2012

■ Public Scoping Period: Letters sent April 17; Comments due May 17, 2012

- | | |
|----------------------|-----------------------------|
| ○ May 17, 2012 | Public Meeting #1 |
| ○ May 31, 2012 | Artist Introduction Meeting |
| ○ September 20, 2012 | Public Meeting #2 |





Roosevelt Street:
1st Street to
2nd Street,
2004 Aerial Image





Roosevelt Street:
1st Street to
2nd Street,
2005 Aerial Image



Prepared by:
RITICH POWELL & ASSOCIATES
10000 W. CENTRAL AVENUE, SUITE 100
DENVER, CO 80202
TEL: 303.733.1100
WWW.RITICHPOWELL.COM

Prepared for:
SEVENTH ROW
10000 W. CENTRAL AVENUE, SUITE 100
DENVER, CO 80202
TEL: 303.733.1100
WWW.RITICHPOWELL.COM

Project No.:
10000 W. CENTRAL AVENUE, SUITE 100
DENVER, CO 80202
TEL: 303.733.1100
WWW.RITICHPOWELL.COM

Date:
10000 W. CENTRAL AVENUE, SUITE 100
DENVER, CO 80202
TEL: 303.733.1100
WWW.RITICHPOWELL.COM

Need and Purpose

- “Roosevelt Row” corridor lies between Grand Avenue and 16th Street along Roosevelt Street
- Convenient access to light rail, local buses, and Arizona State University (ASU) downtown campus
- Local businesses attracts pedestrians
- Large events such as “First Fridays”, Harvest Festival, Sidewalk Sales and “Third Fridays” attract even larger crowds



Project Scope of Work

- Roosevelt Street, Central to 4th Street, 1600 feet
- Narrow the street by re-aligning the curb and gutter towards centerline
- Add bike lanes
- Widen existing sidewalks up to 20-feet
- Provide new LED street and pedestrian lights
- Adjust existing utilities as needed
- Improve existing City owned right-of-way triangle between 3rd and 4th Street
- Add drought tolerant shade trees along Roosevelt Street
- Add drip irrigation to new landscape as needed
- Provide Art element within project corridor



Commitment Resolution

May 17, 2012 Public Meeting

<ul style="list-style-type: none"> ▪ Inclusion of bike lanes. ▪ Looking forward to the bike lanes and trees. ▪ The bike lane is a good idea that should be stretched though Roosevelt. 	<ul style="list-style-type: none"> ▪ Bike lanes are included in project.
<ul style="list-style-type: none"> ▪ Need to address flare if bike lane drops. 	<ul style="list-style-type: none"> ▪ This is needed to allow traffic to move through intersection. If traffic study warrants removal, flare can be removed.
<ul style="list-style-type: none"> ▪ Wider sidewalk between Central and 1st Street. 	<ul style="list-style-type: none"> ▪ Sidewalk on north side has been widened to 20'. Southside could be done with redevelopment.
<ul style="list-style-type: none"> ▪ Why are we replacing concrete sidewalks with more concrete? This is not the appropriate solution to a great opportunity to replace with a different, less heat island contributing material. Let's be imaginative. 	<ul style="list-style-type: none"> ▪ Alternative materials will be explored, but budget will limit amount of more expensive materials. Maintenance is also a factor.
<ul style="list-style-type: none"> ▪ Shade for peds waiting at lights. ▪ Shade. ▪ Trees will add to the equity of the alternate experience. 	<ul style="list-style-type: none"> ▪ As many shade trees will be added where there are no utility conflicts. Artist's designs will also address shade.

Commitment Resolution

May 17, 2012 Public Meeting

<ul style="list-style-type: none"> Gateway signage at triangle. 	<ul style="list-style-type: none"> Signage will be addressed later in design.
<ul style="list-style-type: none"> Parallel parking everywhere! Where's the parallel parking? 	<ul style="list-style-type: none"> Parallel parking has been removed at request of adjacent property owners. As development occurs, parallel parking can be added if owner wants on-street parking.
<ul style="list-style-type: none"> Add plaza (between slip lane and small triangle on south side of Roosevelt/3rd Street). 	<ul style="list-style-type: none"> Developer of vacant property may request to abandon slip lane and incorporate this area into new development.
<ul style="list-style-type: none"> Make (Farmer Leavitt) use the alley. (Remove driveway). No driveway, use the alley (florist shop). 	<ul style="list-style-type: none"> City cannot legally remove access to private property.
<ul style="list-style-type: none"> Sharper corners. 	<ul style="list-style-type: none"> Minimum turning radii allow larger vehicles to turn corners without mounting curbs or turning into opposing traffic.

Commitment Resolution

May 17, 2012 Public Meeting

- Eliminate southbound left turn lane on 4th Street. Expand triangle.
- Eliminate right turn lane east of 4th Street.
- Reduce 4th Street to two northbound lanes.
- Eliminate southbound lane and expand small triangle on south side of 3rd Street and Roosevelt.
- Project limits for grant funding do not include north/south streets. Current budget will fund only construction along Roosevelt Street.



Layout – Design

- Existing Roosevelt Street:
 - 2 lanes with center turn lane and parallel parking
- Proposed Roosevelt Street:
 - 2 lanes with center turn lane, bike lanes and wider pedestrian areas (up to 20-foot wide)
 - Parallel parking removed at request of adjacent property owners

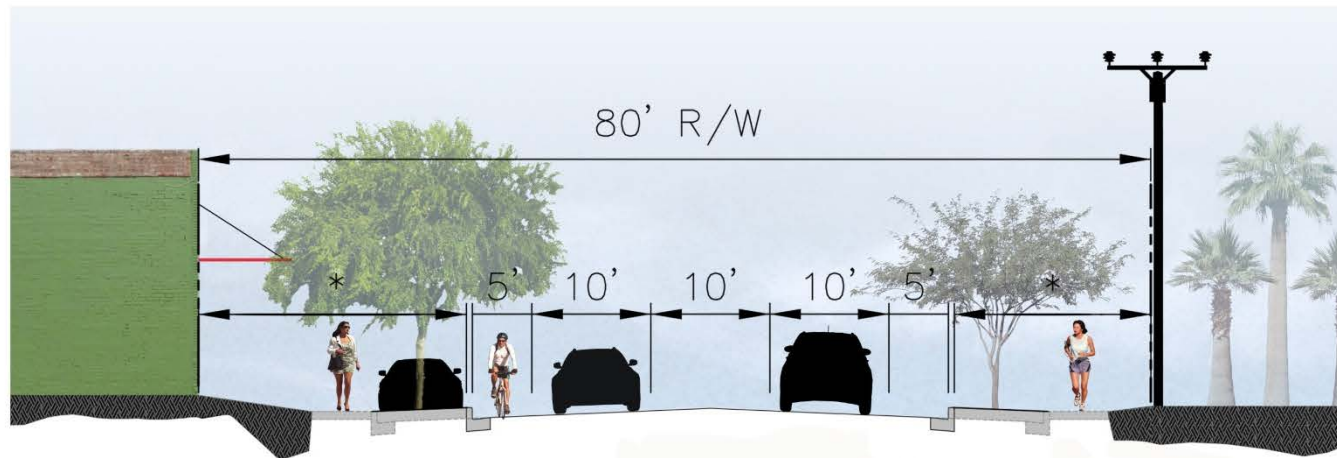

40' ROADWAY
WITH 5' BIKE LANES
LOOKING EAST

Layout - Design (cont.)

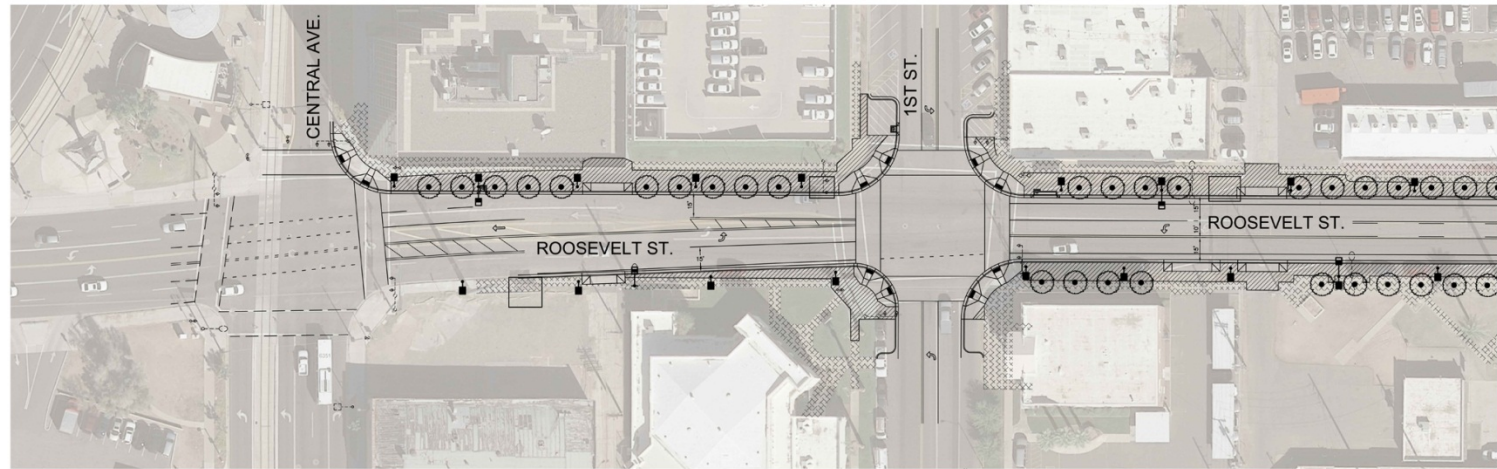

LEGEND

-  EXISTING SIDEWALK
-  PROPOSED SIDEWALK

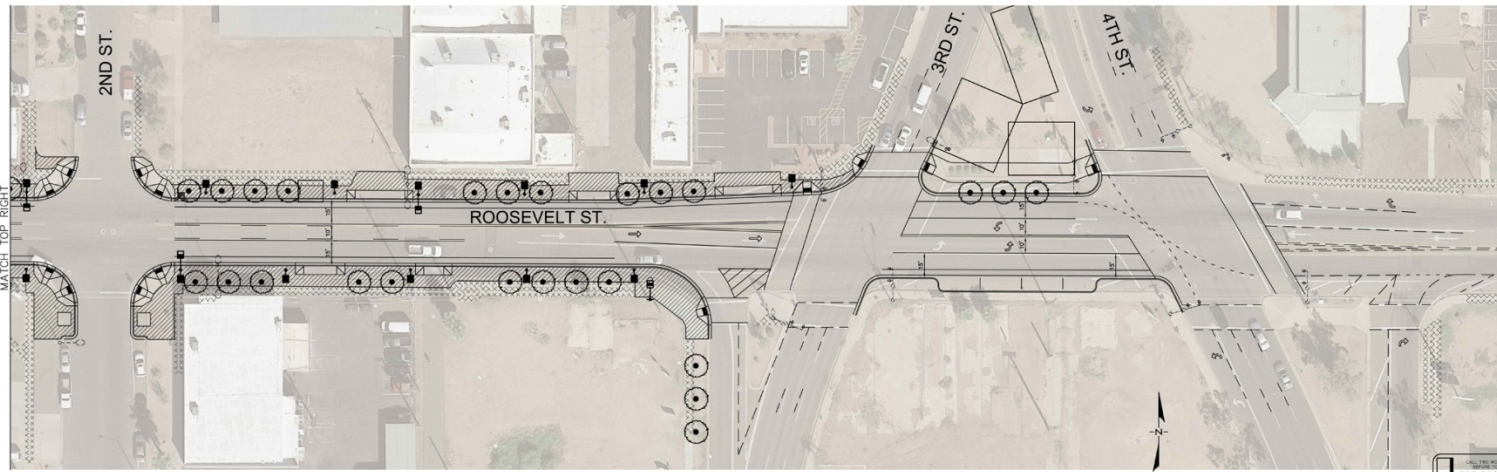

602-263-1100
1-800-STAKE-IT
RITCOHPW.COM

TRACS#0000-MA-PHX-SL618 020

Layout – Design (cont.)



THANK YOU

A special thank you to all those who have supported this project and helped make it a reality. Your contributions and feedback were invaluable in creating a better street for everyone.

City of Phoenix
Department of Public Works
City Engineer: [Name]
City Manager: [Name]

Neighborhood Councils
Central Avenue Neighborhood Council
Roosevelt Street Neighborhood Council
4th Street Neighborhood Council

Community Groups
Phoenix Urban League
Phoenix Chamber of Commerce
Phoenix Business Improvement District

Design Team
Ritoch Powell & Associates
Civil Engineering & Surveying Consultants
Project Manager: [Name]
Lead Designer: [Name]

Other Contributors
Phoenix Police Department
Phoenix Fire Department
Phoenix Public Works Department

Layout - Design (cont.)

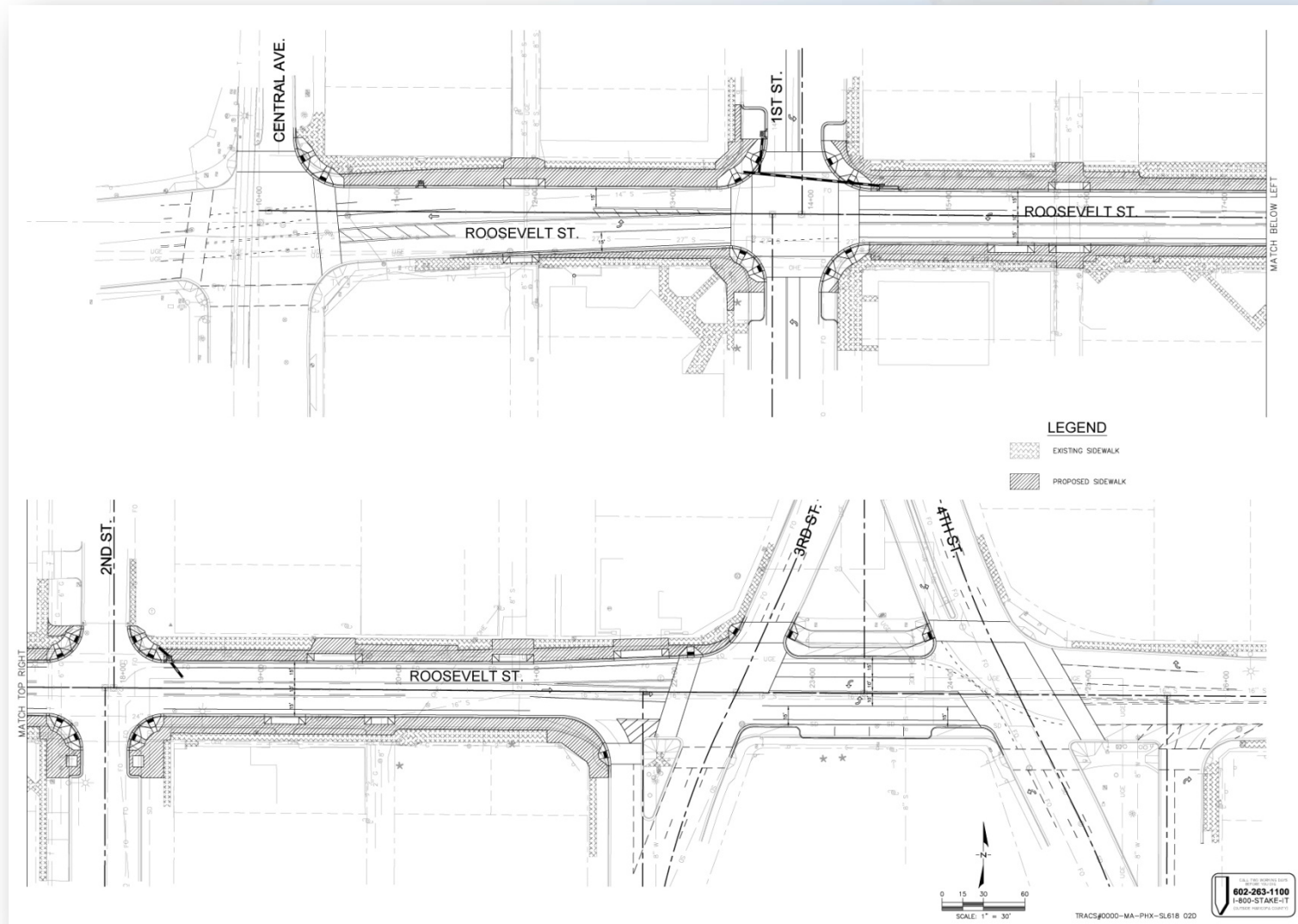

Landscape

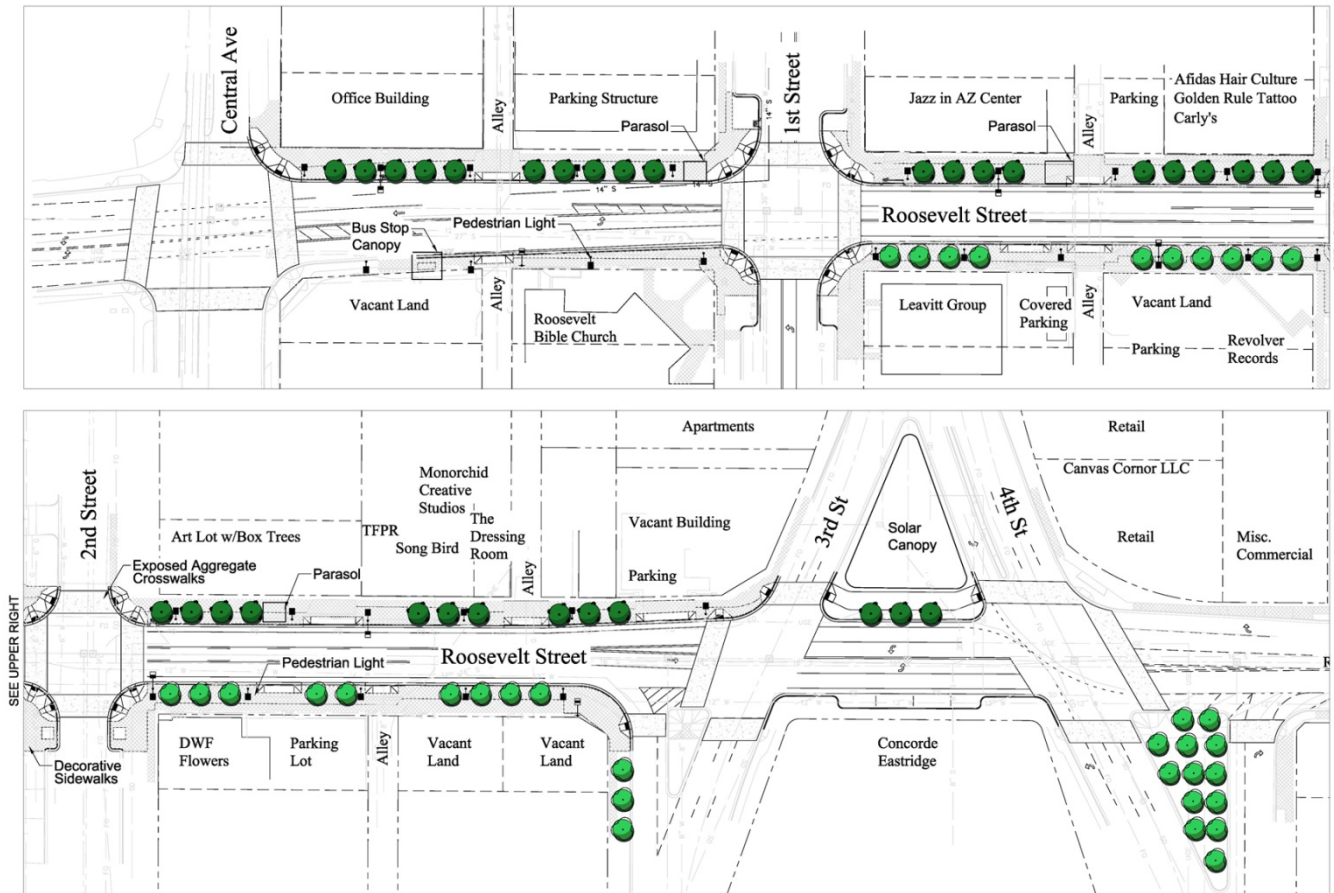

City of Phoenix

Roosevelt Row

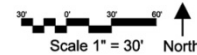

RITCOH-POWELL & ASSOCIATES
Civil Engineering and Surveying Consultants

Webb & Associates
Landscape Architecture
1000 N. Central Ave., Suite 1000
Phoenix, AZ 85004
Tel: 602.254.1100
Fax: 602.254.1101
www.webbassoc.com

Landscape (cont.)

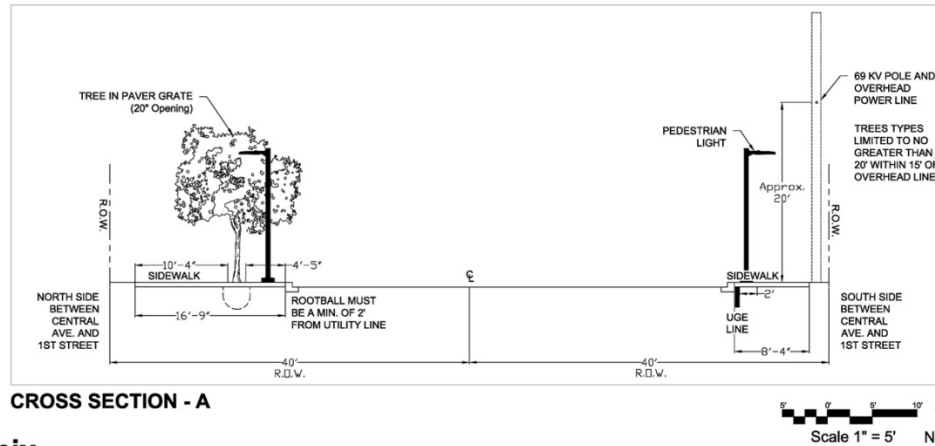
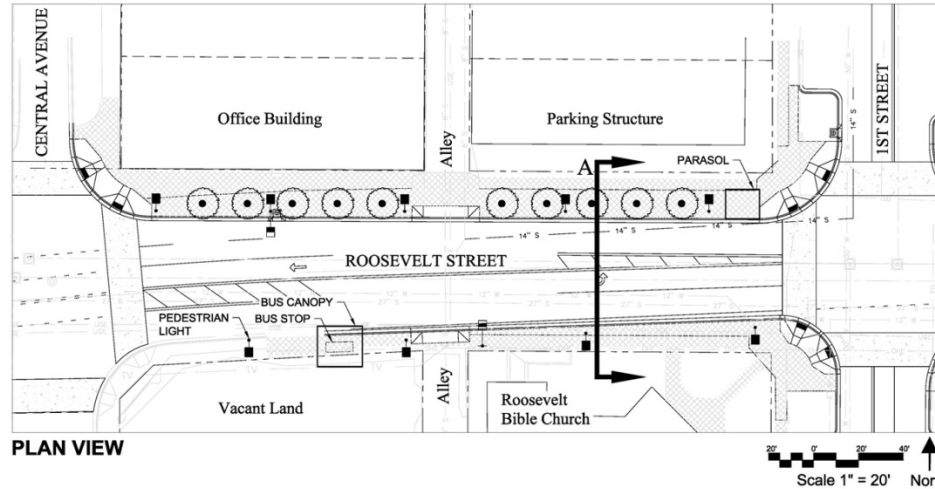

City of Phoenix

Roosevelt Row

BETWEEN CENTRAL AND 1ST STREET



Landscape (cont.)

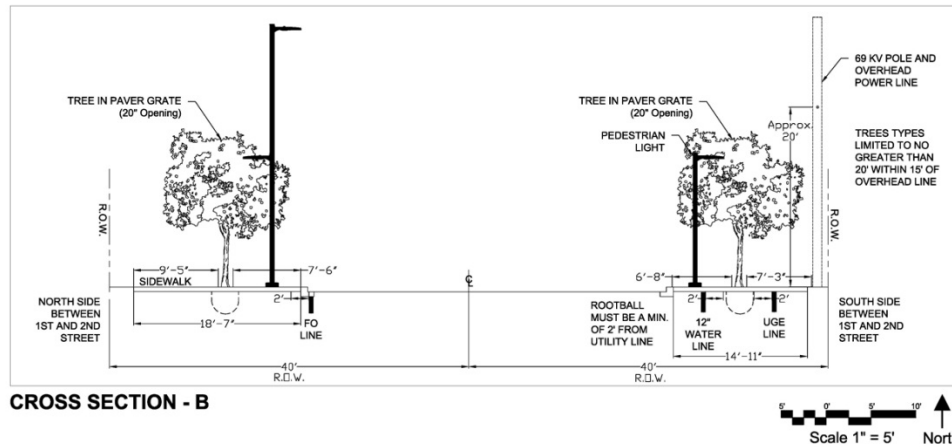
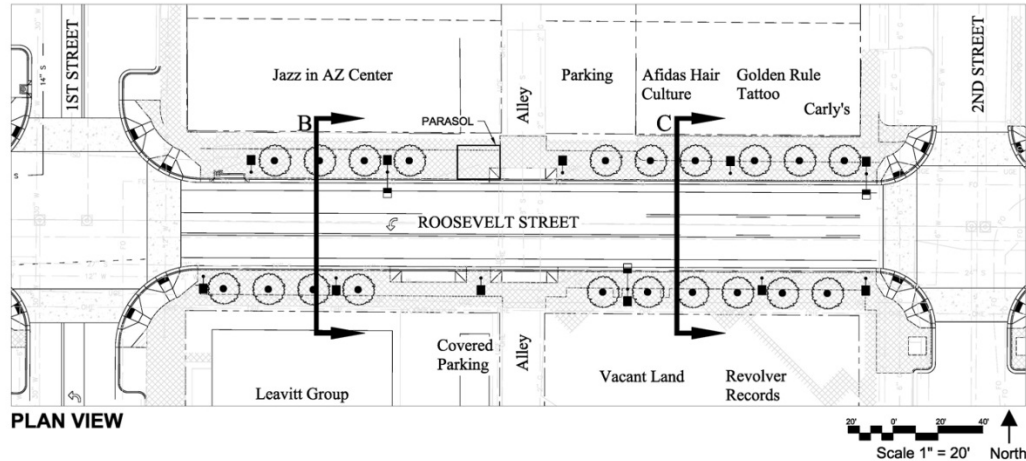

City of Phoenix

Roosevelt Row

BETWEEN 1ST STREET AND 2ND STREET



Landscape (cont.)

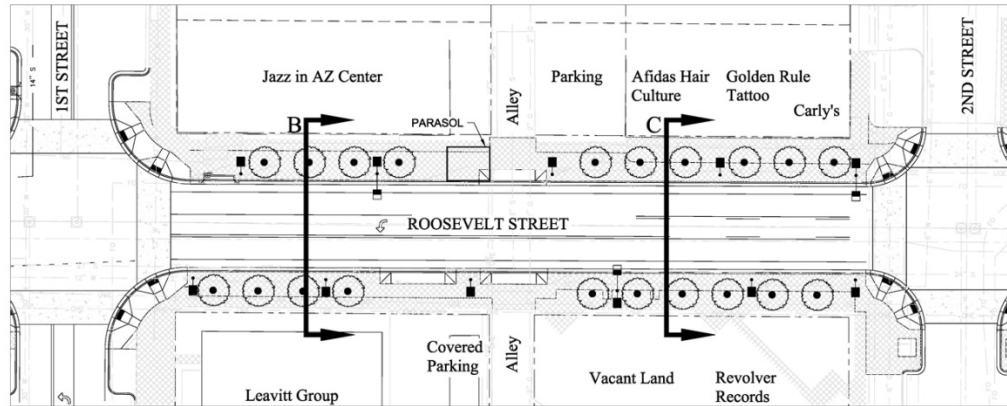

PLAN VIEW

Scale 1" = 20' North

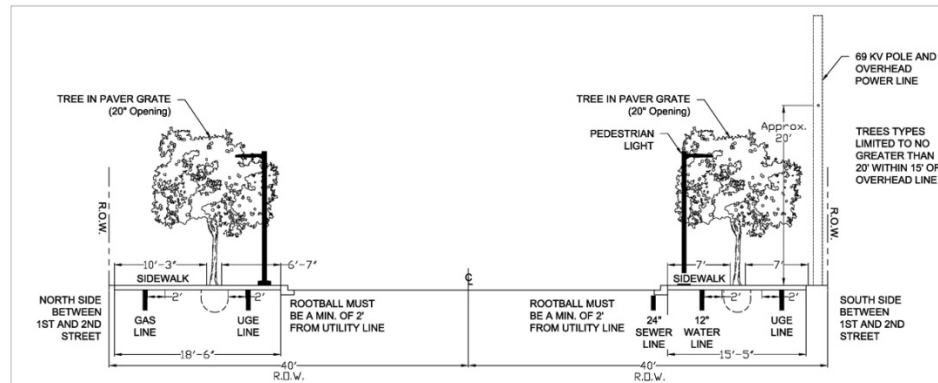

CROSS SECTION - C

Scale 1" = 5' North



City of Phoenix

Roosevelt Row

BETWEEN 1ST STREET AND 2ND STREET



Landscape (cont.)

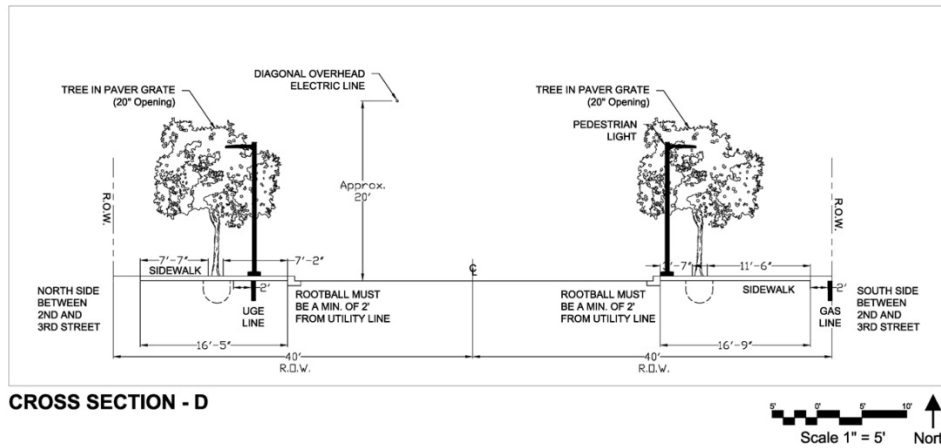
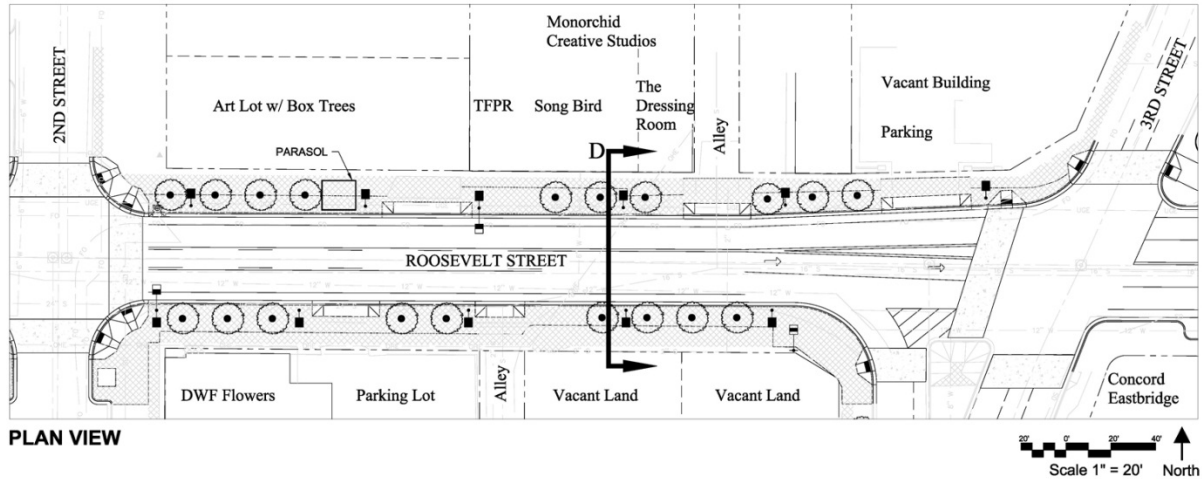

City of Phoenix

Roosevelt Row

BETWEEN 2ND STREET AND 3RD STREET



Landscape (cont.)

Tree Options - North Side of Roosevelt Street



Quercus virginiana 'Heritage'
Heritage Live Oak



Ulmus parvifolia
Evergreen Elm



Dalbergia sissoo
Indian Rosewood



Caesalpinia cacalaco 'smoothie'
Thornless Cascalote

Tree Option - South Side of Roosevelt Street

Tree Grates



Camelia - Ironsmith



Conquistador - Ironsmith



ADA - Ironsmith

Paver Grates



Paver Grate - Ironsmith

Trim Rings



Del Sol Style Trim Ring - Ironsmith

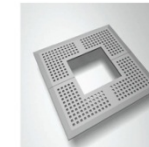

Market Street Style Trim Ring - Ironsmith

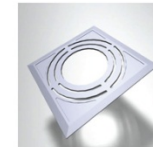

Concentric Style Trim Ring - Ironsmith



City of Phoenix

Roosevelt Row

Trees and Tree Grate Options



Landscape (cont.)

Benches



Sit - landscapeforms



Stay - landscapeforms



Balance Bench - forms + surfaces

Bicycle Racks



Emerson - landscapeforms



Ride - landscapeforms



Capitol - forms + surfaces



Bola - landscapeforms

Trash Receptacles



Pitch - landscapeforms



Dispatch - forms + surfaces



Knight - forms + surfaces



City of Phoenix

Roosevelt Row

Benches, Trash Receptacles and Bicycle Racks





Landscape (cont.)

Renderings



3rd Street looking South West



3rd Street looking South West



2nd Street looking North



2nd Street looking North



City of Phoenix
Roosevelt Row

Perspective Renderings



Schedule

- Federal Design Funds Authorized – September 1, 2011
- Environmental Clearances – Completed (Sept 2011 – Aug 2012)
- 30% Design – Completed (Dec 2011 – May 2012)
- 70% Design – November 2012
- 90% Design – February 2013
- Final Plans and Construction Documents – May 2013
- Final Plans and Construction Documents to ADOT – June 2013
- Federal Funds to be Obligations by – October 2013
- Bid Opening – December 2013
- Construction Begins – May 2014
- Construction End – September 2014